

User Manual for Illumination Module for Peak Zoom Magnifier 2044 and 2066

Charging the Light Module

The connection for charging is located under the rubber cover at the end opposite where the light source is: Use a USB-C cable and an ordinary USB compatible power supply, or alternately a USB-C port on a computer etc.

Near the USB connector is the On/Off button and 4 indicator lights: During charging, these indicator lights blink or light up. When all four are lit, without blinking, the lamp's battery is fully charged.

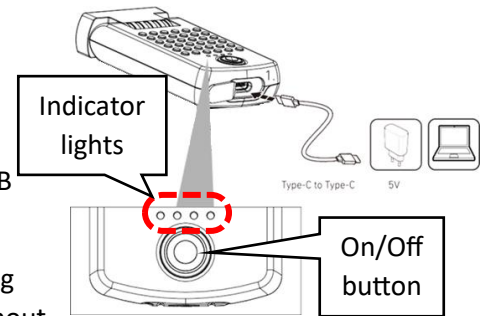

Assembling the Module

Push the magnifier into the arched holder as shown to the right, until it "snaps" into position.



Push the lamp into the rectangular holder until it "snaps" into position, as shown to the left.



Turning On/Off

To turn the light on, press the On/Off button; this activates the low-power light (60 lumens). To switch to higher-power light (220 lumens), press the button again *within 3 seconds after turning the light on*.

To turn the light off, press the button again.

Button Lock

The light can be "locked" to prevent it from turning on unintentionally. With the light turned off, press the button down and *hold it pressed* for 5 seconds. The lamp gives 3-4 short flashes to indicate that it is now locked.

If the user tries to turn the lamp on with a short press on the button, the lamp gives two short flashes to indicate that it's locked and then remains turned off.

To unlock the lamp, allowing it to be turned on, press the button down and *hold it pressed* for 5 seconds. The lamp gives 3-4 flashes to indicate that it is now unlocked. Hereafter, the light can be turned on the usual way with a short press on the button.