

# ShineLink-X User Manual

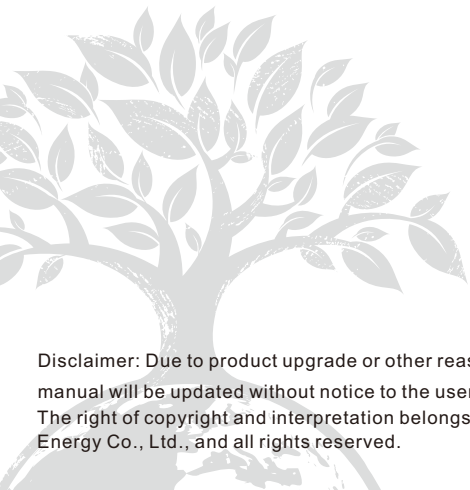

Disclaimer: Due to product upgrade or other reasons, the contents of this manual will be updated without notice to the user. The right of copyright and interpretation belongs to Shenzhen Growatt New Energy Co., Ltd., and all rights reserved.

## 1. Product Overview

ShineLink-X is compatible with all on-grid inverters with the USB port, which enables remote monitoring and maintenance of PV systems through the LAN cable.

- > Supports mobile APP and server web page monitoring
- > Supports local commissioning and firmware upgrade
- > Supports local data saving and break point retransmission

## 2. Product Appearance



Item	Name	Description
A	Power input	Connect to the power adaptor
B	RS 485	Reserved
C	RJ 45	Connect to the network
D	Key	Function key
E	Configuration LED	Configuration the device
F	Device LED	Device number connected
G	Network LED	Connecting the network
H	Power LED	Connecting the power

## 3. System Diagram

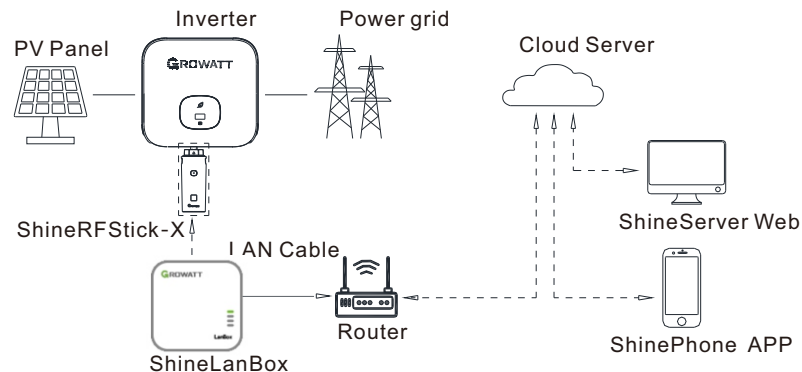

## 4. Installation and Configuration

### 4.1 Installation instructions

1. Rotate the USB cover of the photovoltaic device counterclockwise.
2. Rotate the datalogger locker on the upper, make sure the triangle is on the front side and in the middle.
3. Connect the datalogger to the inverter USB port, make sure the triangle is on the front side, press the locker and rotate clockwise until it is tighten.

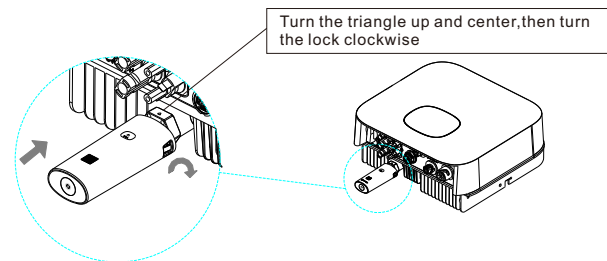

After the installation, if the LED light of ShineRFStick-X flashes quickly, it means installation works. If the LED light is off, please recheck the connection between ShineRFStick-X and inverter.

ShineRFStick-X's LED status	Status of the ShineRFStick-X
Always on	The ShineRFStick-X is initialing
Always off	Loose connection
Flashing quickly (every 0.2 second)	USB port find the inverter
Flasing slowly (every 1 second)	Connection works

Connect ShineLanBox's RJ45 port to the router, then plug in ShineLanBox with power adaptor. After initialization of ShineLanBox, the power LED is on, the network LED is on and the device LED flashing frequently.

ShineLanBox LED lights	Status of working condition
Power light	The light is on means power is on
Web light	Flashing means connect to router, on means connect to web
Device light	Time of frequently flashing means the number of device connect to ShineLanBox
Paired light	Flashing when pairing, go off if pairing

#### 4.2 Datalogger configuration

1. Scan the QR code below to download ShinePhone, or you can search for ShinePhone in AppleStore or Google Play, download and install it.

2. Once the APP is installed, you can configure the datalogger and add the PV plant as prompted. For details about the datalogger configuration, please refer to ShineLan-X Configuration Guide, which can be downloaded by scanning the QR code below.



【ShinePhone APP】



【ShineLink-X Configuration Guide】

#### 4.3 ShineLink-X button description

	Button operation	Description
ShineLanbox	Short press	Set ShineRFStick-X into pairing state
	Press and hold for 6s until the white light is on	Restore to factory settings (it is set to dynamic IP by default)
ShineRFStick-X	Short press	Set ShineRFStick-X into pairing state
	Press and hold for 6s until the white light is on	Restore to factory settings (it is set to dynamic IP by default)

#### 4.4 Quick troubleshooting

ShineRFStick-X's LED status	Status of the ShineRFStick-X	Troubleshooting
Always on	The ShineRFStick-X is initialing	Wait 30s for initialization to complete
Always off	Loose connection	Re-plug the datalogger
Flashing quickly (every 0.2 second)	USB port find the inverter	Wait for the pairing with ShineLanbox to complete
Flasing slowly (every 1 second)	Connection works	Normal working state

#### 5. Specification

##### 5.1 ShineLanbox 's specification

Type	Item	Parameter
General parameters	Dimensions (L/W/H)	105mm/85mm/26mm
	Weight	103g
	Protection degree	IP30
	Relative humidity (non-condensing)	5-95% RH
	Certificates	CE, RoHS
Electrical parameters	Nominal voltage	5V(±5%)
	Nominal current	1A
	Typical power consumption	3W
	Operating temperature	-20°C ~ +65°C
	Storage temperature	-40°C ~ +70°C

Type	Item	Parameter
Device management	Number of managed devices	3
	Communication	RF wireless
	RF wireless maximum	120m
	Internet access	WLAN
Application parameter	RF wireless band	433MHz
	Supported servers	Shineserver
	Server communication	Modbus TCP
	User configuration Interface	APP configuration
	Data transmission interval	5 mins
	Default server IP address	server.growatt.com

##### 5.2 ShineRFStick-X's specification

Type	Item	Parameter
General parameters	Dimensions (L/W/H)	104mm/47mm/27mm
	Weight	63g
	Protection degree	IP65
	Relative humidity (non-condensing)	5-95% RH
	Certificates	CE, RoHS
Electrical parameters	Nominal voltage	5V(+/-5%)
	Nominal current	1A
	Typical power consumption	3W
	Operating temperature	-20°C ~ +65°C
Storage temperature	-40°C ~ +70°C	

Type	Item	Parameter
Device management	Number of managed devices	1
	Communication	RF wireless
	RF wireless maximum	120m
Application parameter	Supported servers	Not support
	Server communication	Not support
	User configuration interface	Not support
	Data transmission interval	5 mins
	Default server IP address	Not support

Remarks: The maximum RF wireless communication distance is tested in an open distance. If there is an obstacle between ShineLanBox and ShineRFStick-X, the distance will decrease.

#### 6. Declaration of conformity

This product complies with the following regulations and requirements:

- > Electromagnetic Compatibility Directive:2014/30/EU (EMC)
- > Restriction of Hazardous Substances Directive:2011/65/EU(EU) and 2015/863 (RoHS)

> You can download the Declaration of Compliance at <https://www.ginverter.com>.

#### 7. After-sales service Contact

Shenzhen Growatt New Energy CO.,LTD

4-13/F, Building A, Sino-German (Europe) Industrial Park, Hangcheng Ave, Bao'an District, Shenzhen, China

+86 755 2747 1942

service@ginverter.com

www.ginverter.com

