

PARTS OF YOUR BladeFLASK:

INDICATOR:
SHOWS WHICH WAY SHARP
EDGE MUST FACE.

THIS PART OF
THE SCALPEL
HANDLE IS
CALLED THE
TANG.

COUNTER

LANDING
PAD

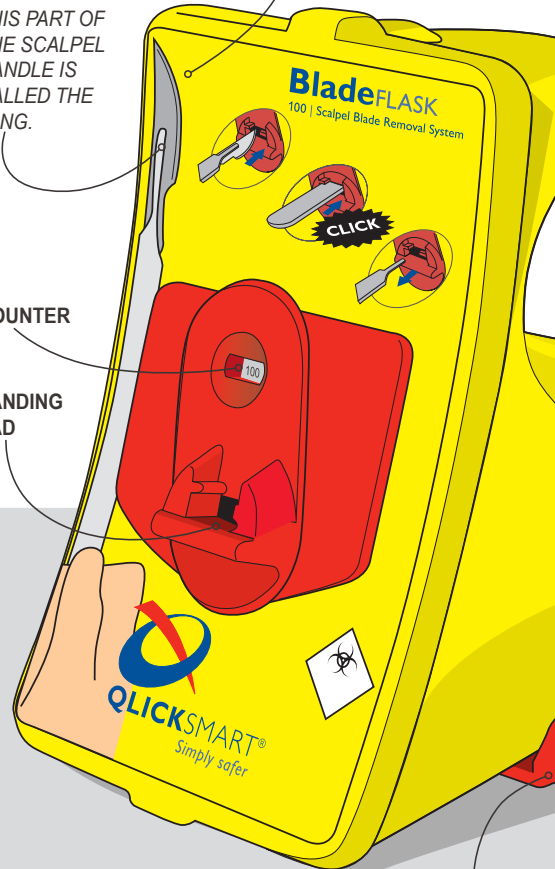

MOUNTING
BRACKET

MOUNT TO WALL OR TROLLEY:

1. If you haven't mounted your BladeFLASK before, prepare mounting bracket*.

A BRACKET HAS DOUBLE SIDED
TAPE ON BOTTOM

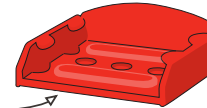

B OR USE SCREWS.



* See fitting template and instructions inside
the bracket packaging.

2. BladeFLASK can
be mounted on
a wall or on a
trolley or bench.

SLIDE
DOWN INTO
BRACKET

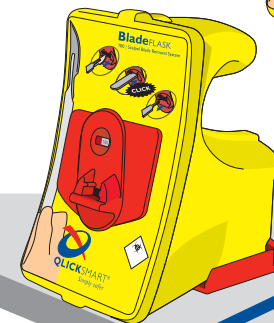
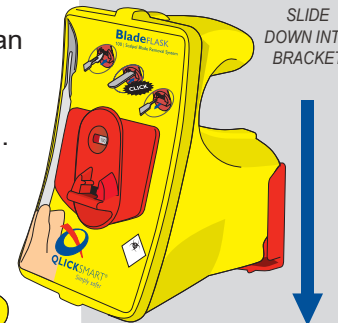

SLIDE
BACK IN TO
BRACKET

NOTE: BladeFLASK is
mounted on Mounting
Bracket during use.

REMOVE BLADE SINGLE-HANDED ACTION:

1. Place blade on
landing pad with
the sharp edge
facing to the
right (or 'tang'
up).

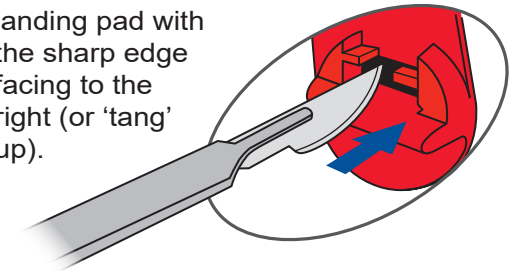

2. Push scalpel
handle into
BladeFLASK
until you
hear a click.

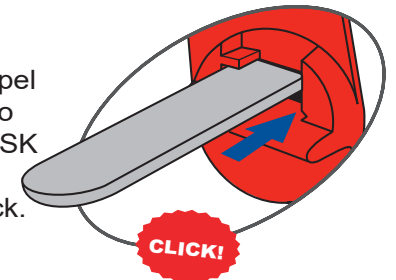

3. Remove handle.

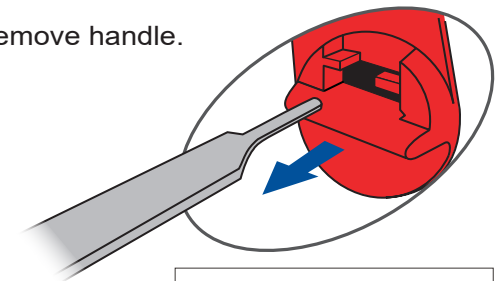

NOTE: BladeFLASK is disposed
of as medical waste after 100
blades have been inserted.