

INSTALLATIE VOORSCHRIFT

INLOOPDOUCHE Safety Glass 2.0

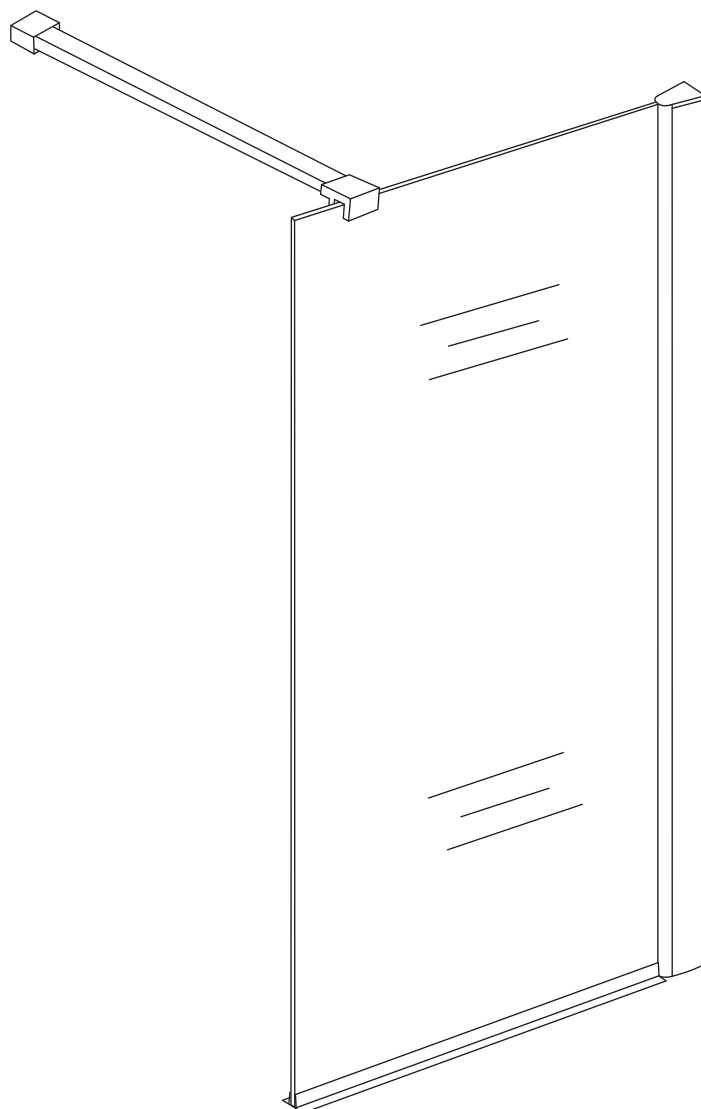

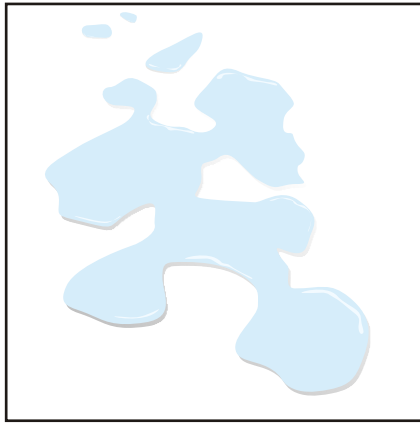

Zonder NANO

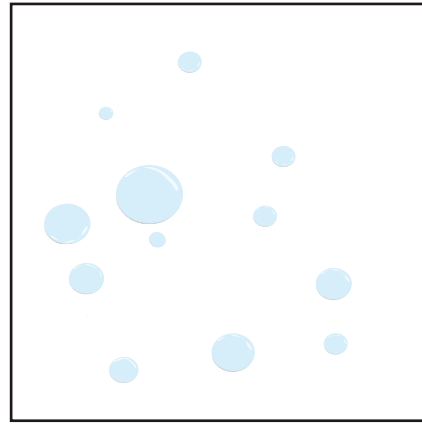

NANO

**NANO kant aan de binnenzijde
Te herkennen aan de sticker**

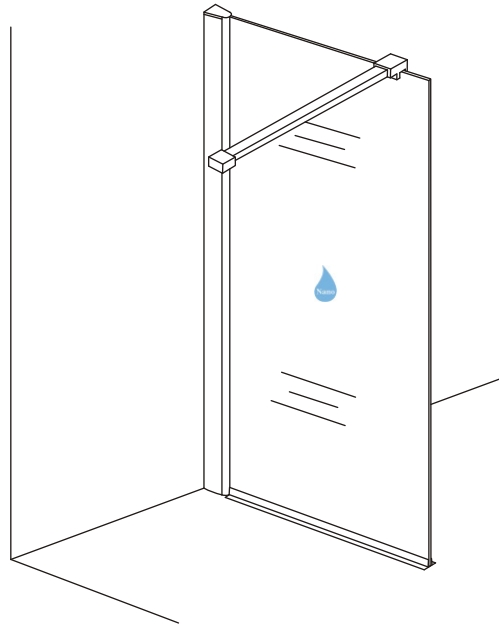

**NANO kant aan de binnenzijde
Te herkennen aan de sticker**

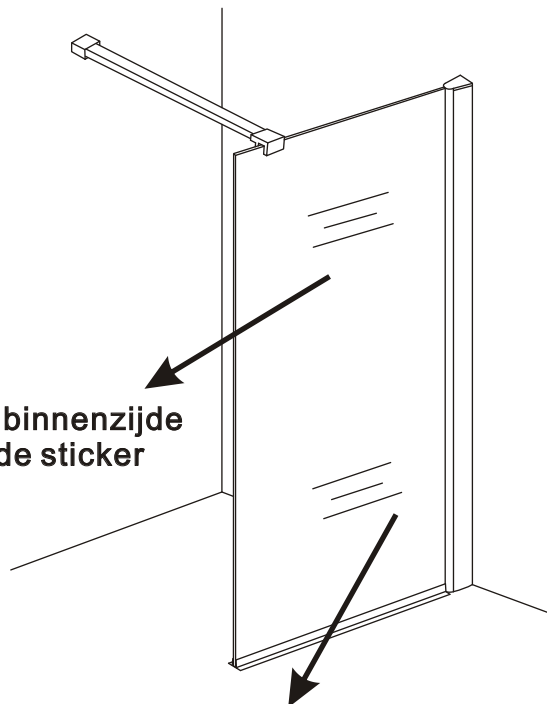

NANO garantie: 5 jaar bij normaal gebruik
**LET OP: gebruik geen grove scherpe voorwerpen, zoals
schuursponsjes of staalwol om het glas schoon te maken.**

1

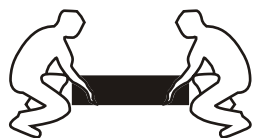
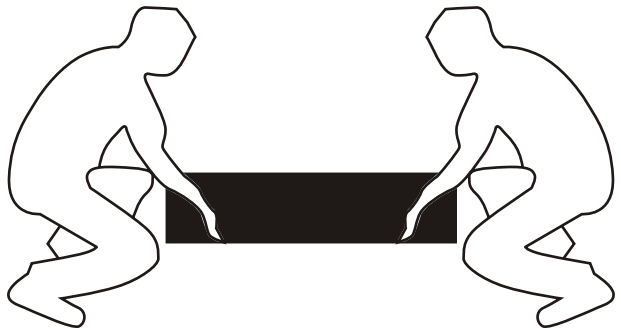
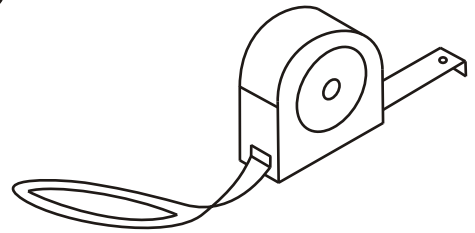
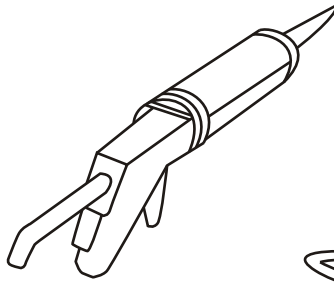
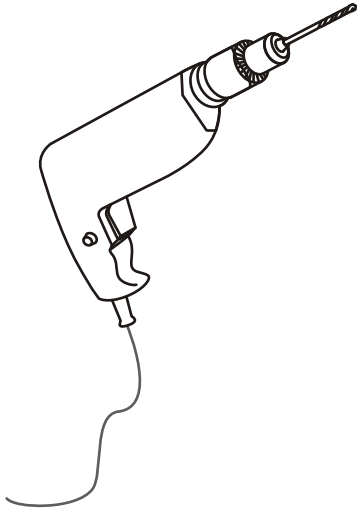
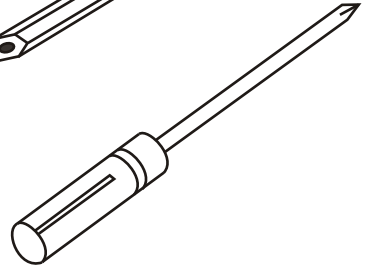
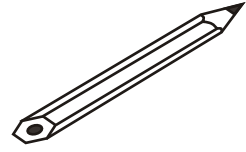
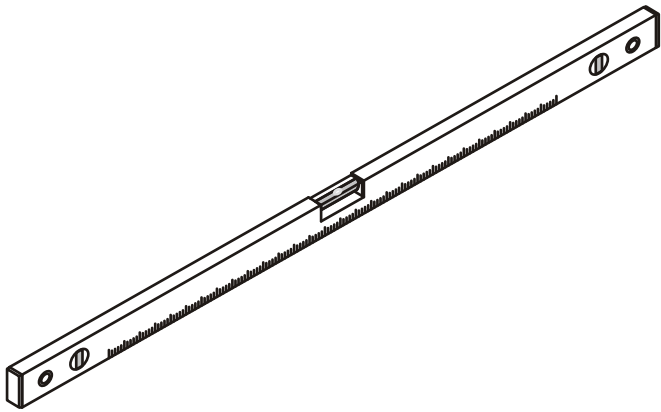

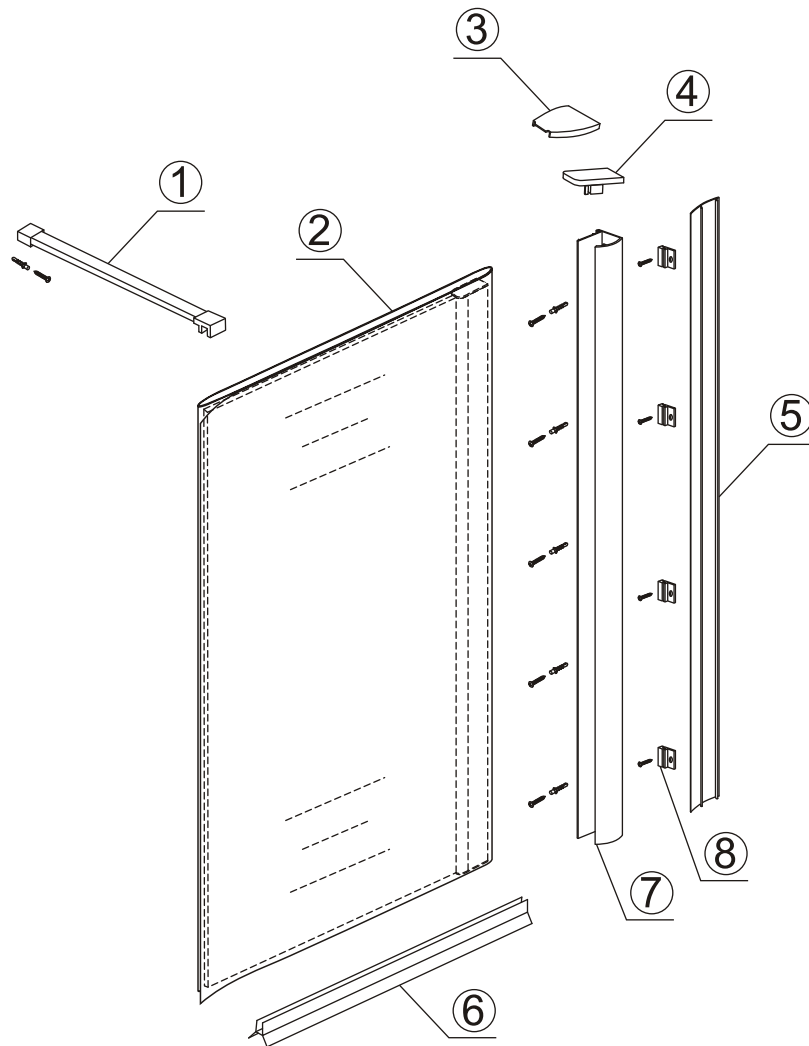

Verwijder de beschermfolie alléén van het glasprofiel .
 De beschermfolie dus op het glas laten zitten voordat
 u klaar bent met installeren . Deze folie beschermt
 namelijk de 3 lagen film van het veiligheidsglas .
 Nadat de installatie voltooid is kunt u de beschermfolie
 in zijn geheel van het glas afnemen .

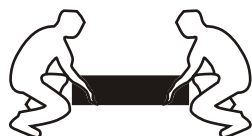
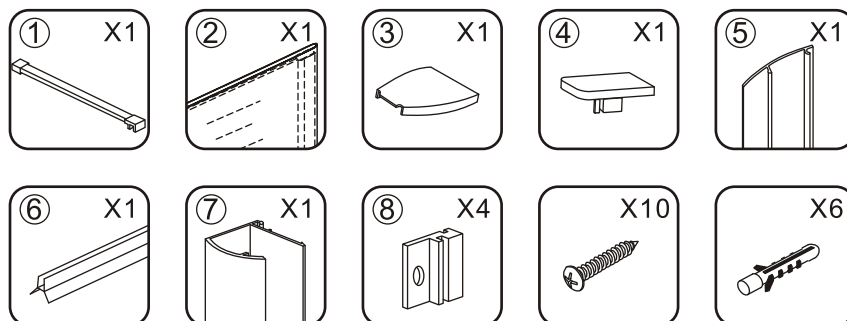

1015(780-800x2000)
1015(880-900x2000)
1015(980-1000x2000)
1215(1180-1200x2000)

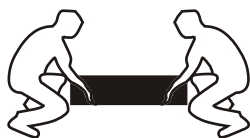
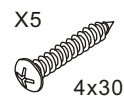
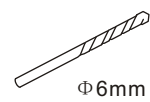
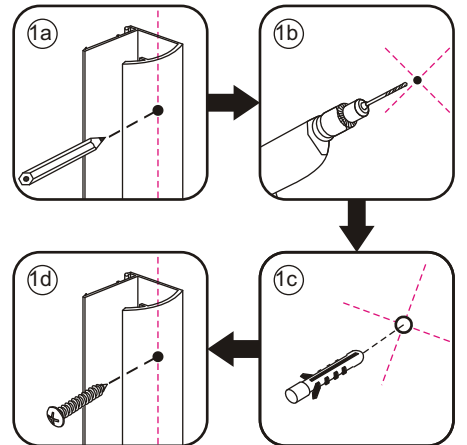
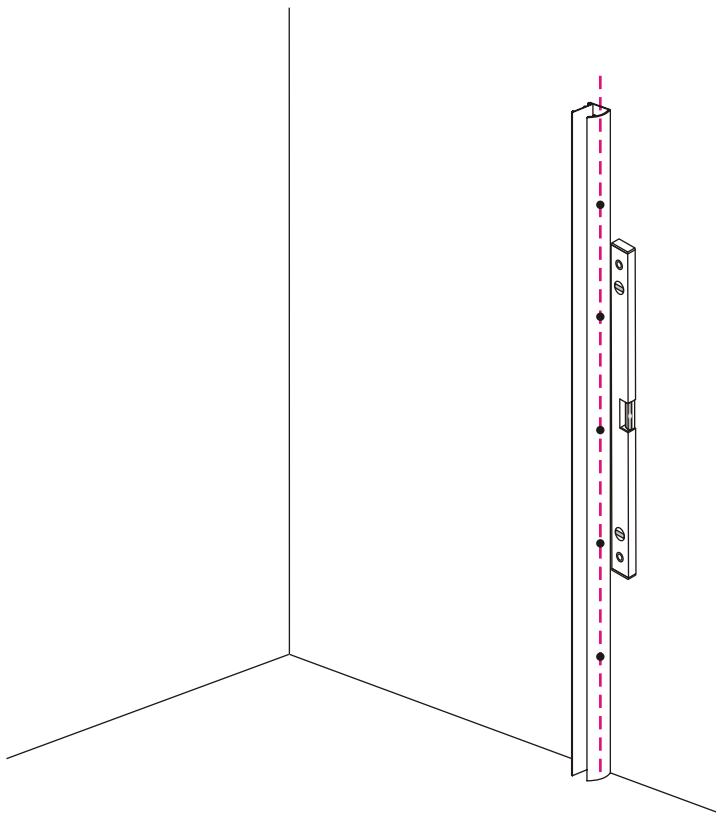
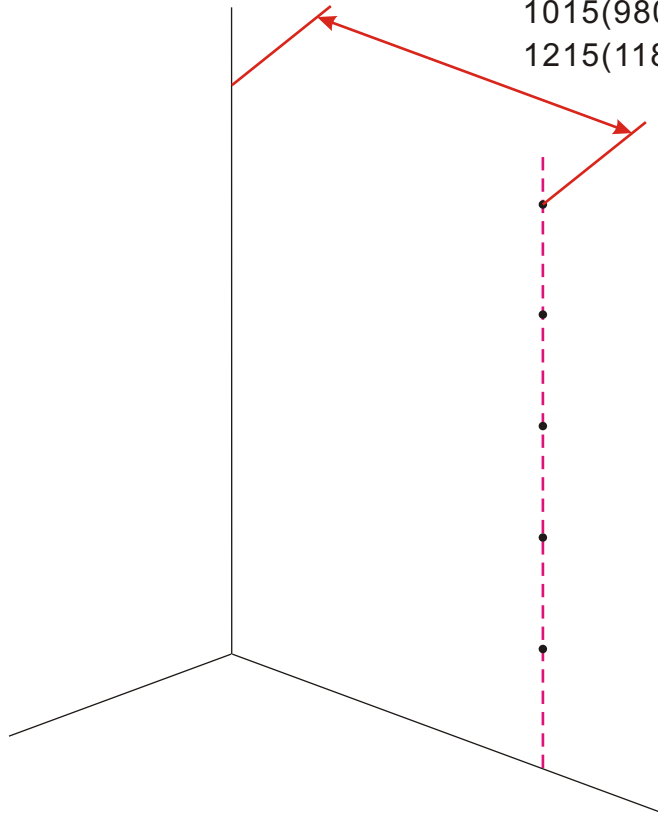

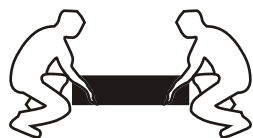
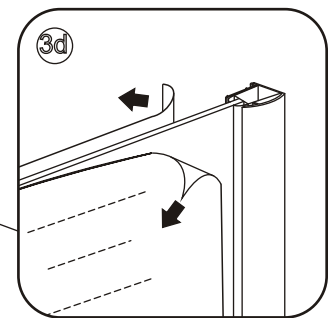
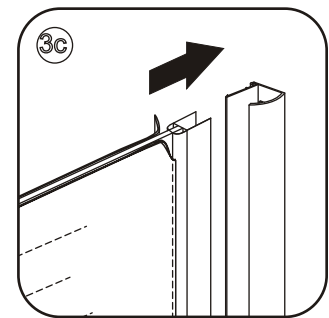
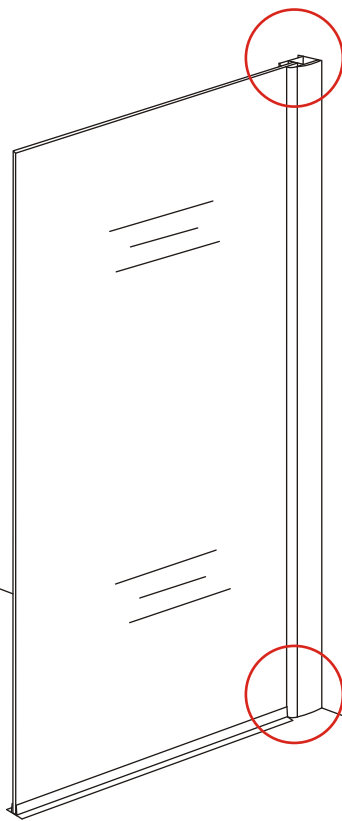
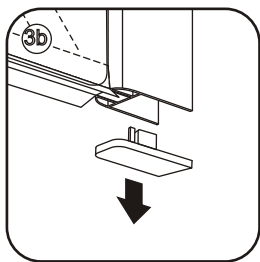
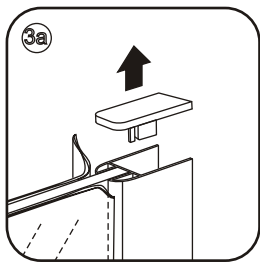
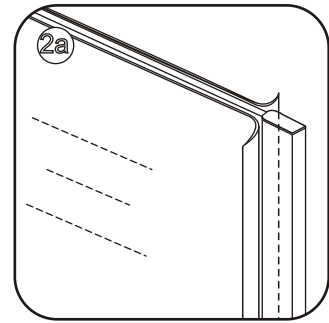
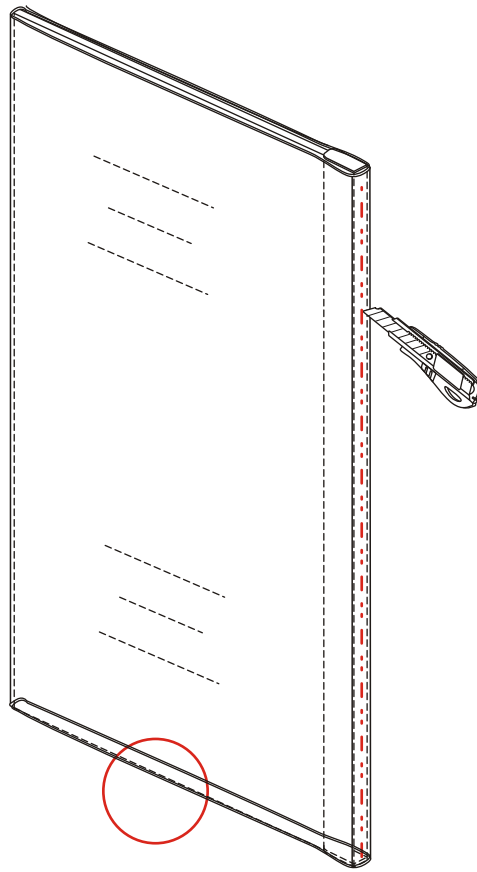
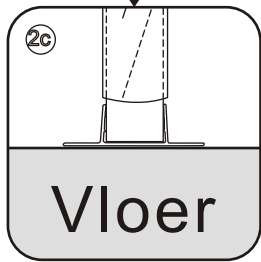
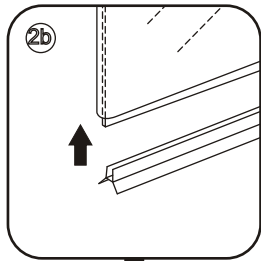

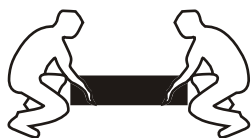
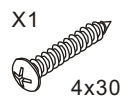
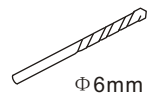
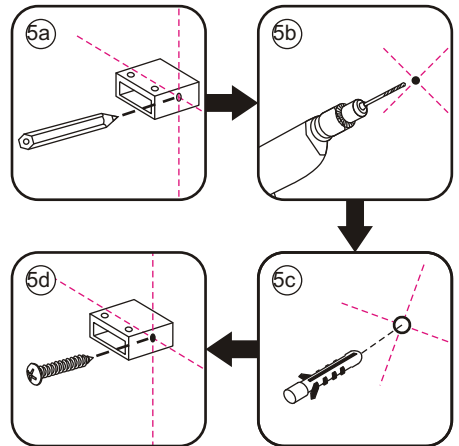
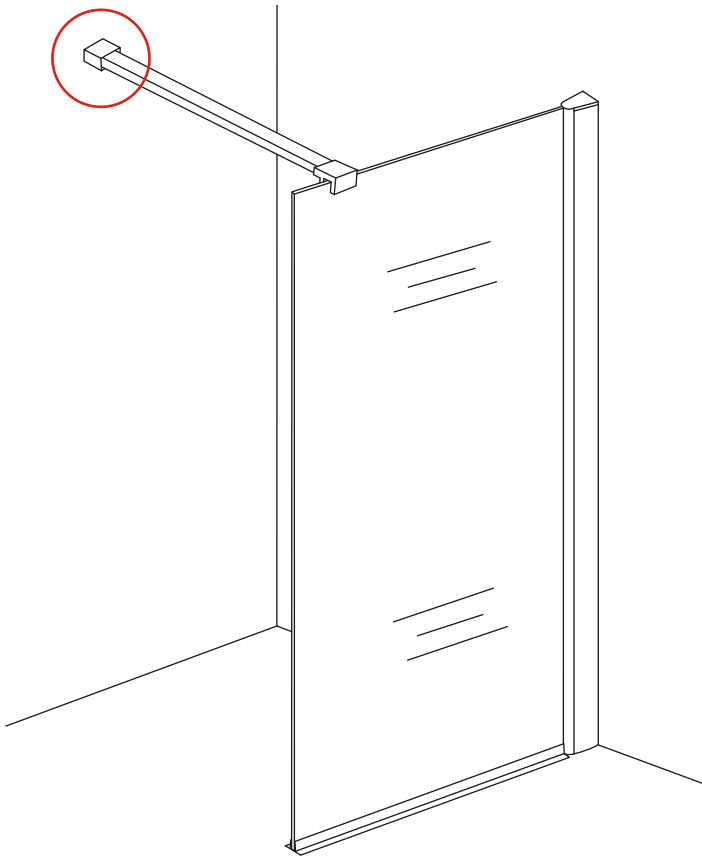
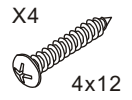
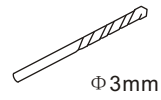
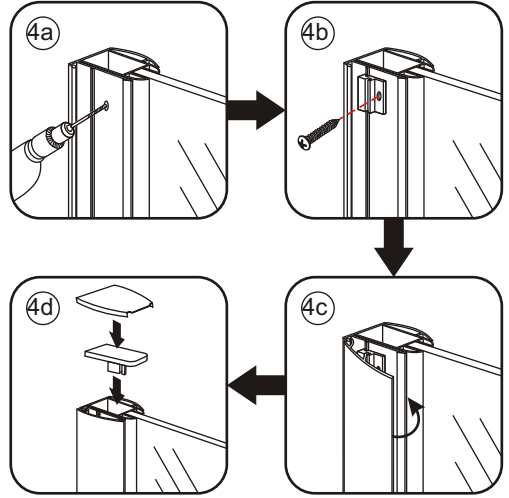
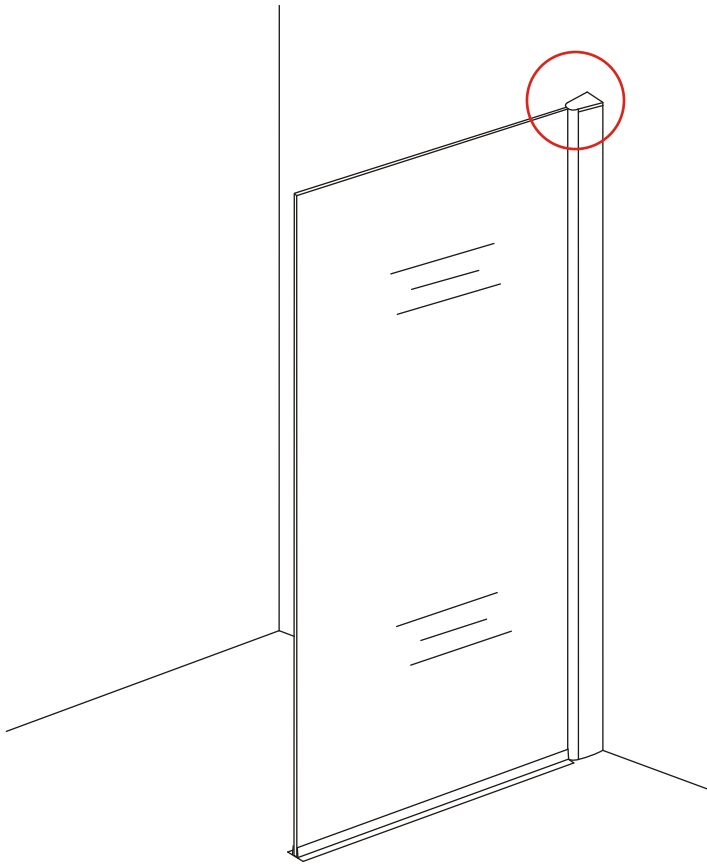

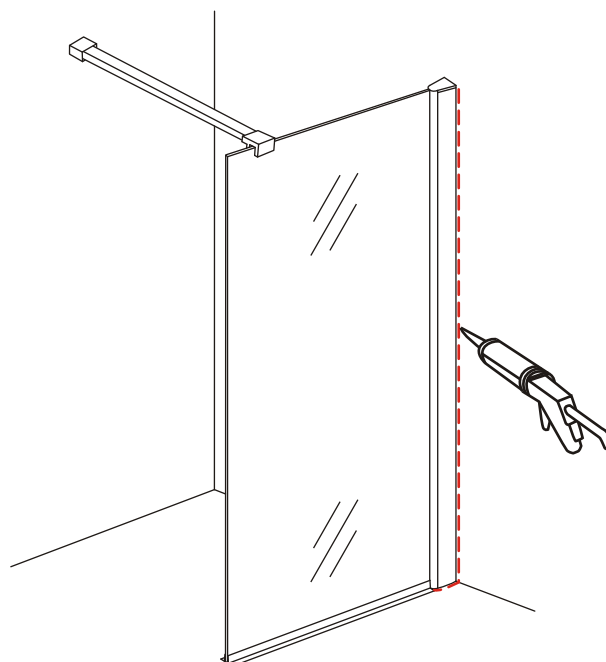
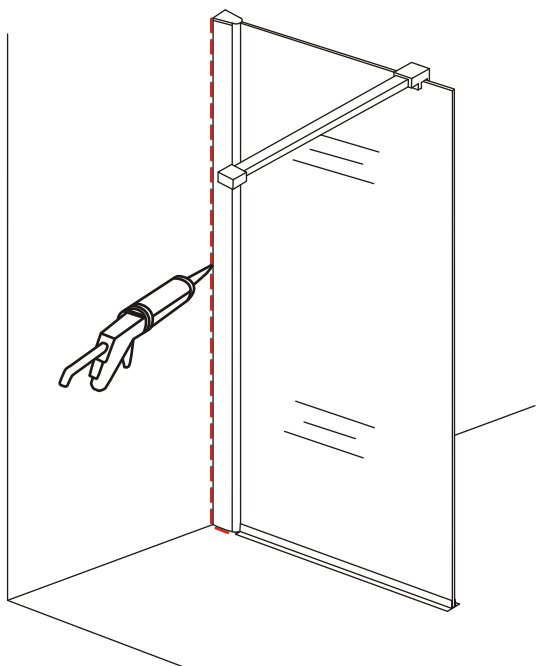
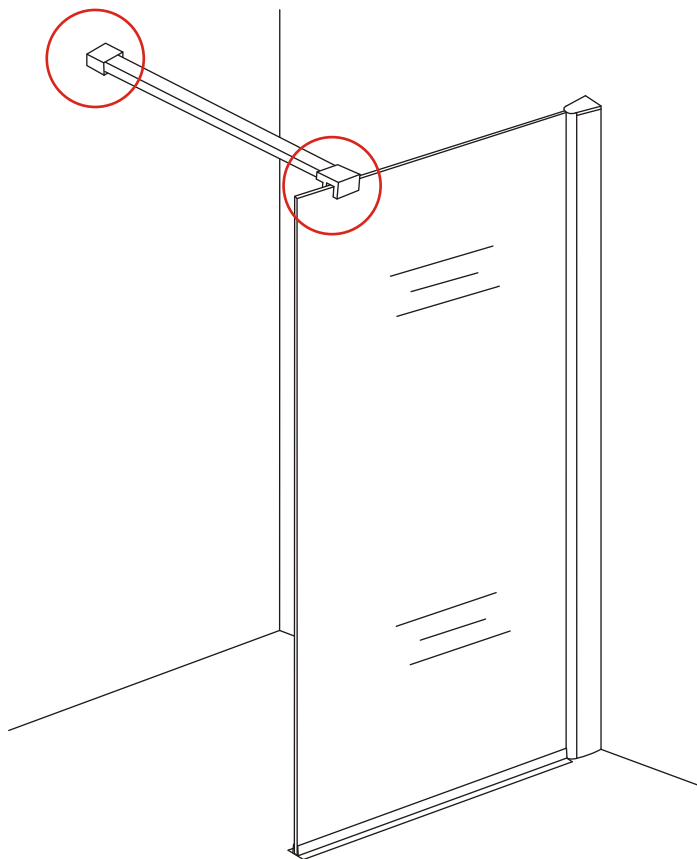
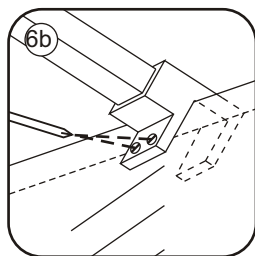
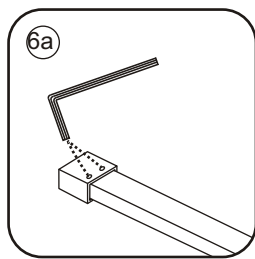

Voorzie beide kanten van het muurprofiel
(binnen- en buitenkant) van siliconenkit.

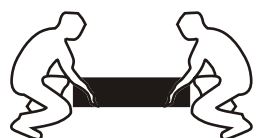

Gebruik een zachte doek om het glas schoon te maken, raak met geen enkel scherp gereedschap de wand aan.

Zachte doek

