

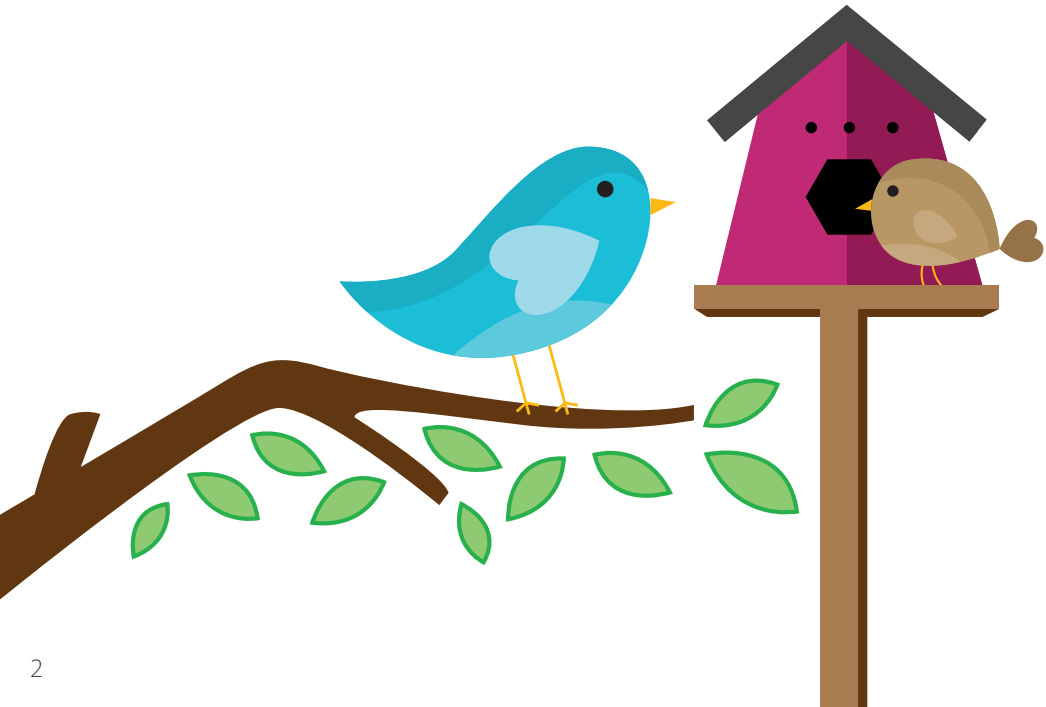

# HD IP Bird Box Camera Kit Quick Start Guide



**Please read me before you start!**



# Contents

1. Camera setup
2. App setup
3. Physical installation
4. Configuring camera settings
5. Installing PC software
6. Accessories
7. Troubleshooting



Watch our setup videos

Don't know where to start?  
Watch our setup videos online.  
🖱️ [green-feathers.co.uk/help](https://green-feathers.co.uk/help)

Congratulations! You are now the proud owner of a Green Feathers Bird Box Camera. For years we have been a leading provider of wildlife cameras and our bird box cameras are a number one choice for those wanting to watch wildlife in their very own garden from the comfort of the sofa.

Please take a couple of minutes to have a read through this booklet before you get started. Not only are there some helpful hints and tips, but we also have some guidelines to help you plan the installation of your camera.

With just a bit of time, a cup of tea and a friend you'll be up-and-running in no time. We hope you enjoy your camera!

# 1. Camera Setup

Before installing the camera in your nest box, **wire it up inside the house first** to make sure everything is working as it should.

## Assemble the weatherproof adaptor

- ✓ **Line up the longer network cable** with the large connector on the trailing cable
- ✓ **Thread the parts over the end of the cable** in the order shown on the diagram (right)
- ✓ **Connect the network cable** jack into the port
- ✓ **Push and twist the pieces into place** from left to right

## Connect your camera to power

- ✓ **Connect the other end of the network cable** to the port labelled **PoE** on the power block as shown in the diagram (right)

## Connect to your router

- ✓ **Connect the short network cable** into the **LAN** port on the power block
- ✓ **Connect the other end into one of the available ports on your network router**
- ✓ You can now **connect the mains power supply** and switch on the power at the wall

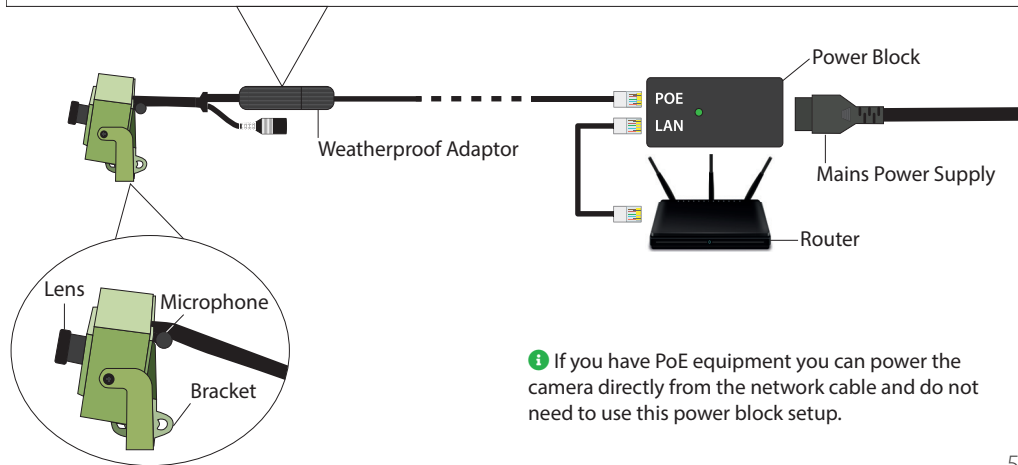
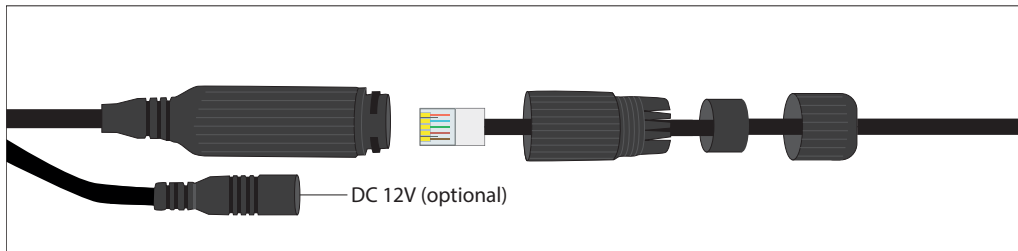

**i** If you have PoE equipment you can power the camera directly from the network cable and do not need to use this power block setup.

## 2. App Setup

### Download the app

📲 Search for **iCSee Pro** on Apple App Store or Google Play Store to download the app to your smartphone or tablet.



✏ Please note down the password for the camera if you have set one. Forgotten passwords will require a camera reset, which may incur a reset fee.

### Add the camera to the app

Open **iCSee Pro** and tap **Local Login**.

Tap the **+** icon on the top-right.

Now tap **More** and **Add device** in the same **WLAN**.

It will now search for any cameras found on your network. The camera should be found, tap on it and it will add it to your device list.

Now tap on the **Play** ▶ button to live view images from the camera.

### 🔍 Camera not being found?

Visit [green-feathers.co.uk/help](https://green-feathers.co.uk/help) and search **NCIP2** for alternative setup guides for your device(s).

## 3. Physical Installation

Now you are ready to mount the camera into your nest box.

### What you will need

- ✓ Camera with bracket (included)
- ✓ 5M screw (included)
- ✓ Nest box (optional)
- ✓ Screwdriver
- ✓ Mains power outlet

### You may also need

- ✓ Drill
- ✓ Pencil
- ✓ Electrical tape
- ✓ Cable fasteners

### Focussing your camera lens

The focus on this camera is manually adjusted. Place a small bird-sized object in your bird box. Loosen the locking collar by the lens. You can gently twist the camera's lens to adjust the focal distance of the camera. Monitor the results on the app until the image is sharp.

## Mount the Camera in Nest Box

### A. Installing in one of our bird boxes:

Pass the 5M screw provided through the pre-drilled hole in the back of the box, screwing into the nut on the easy mount bracket.

Our innovative anti-slip bracket design will hold the camera in place against the wood.

There is a gap in the eaves of the box through which to pass your cables.

### B. If you do not have one of our bird boxes:

Following the diagram (right), drill a 6mm hole at or above 210mm from the base of your box. Then follow the **A** instructions above.

✔ Make sure you are happy with the angle of the camera by checking the image on your app and making any adjustments if need be.

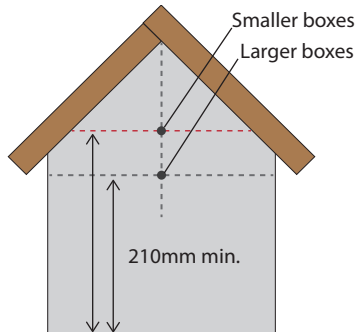
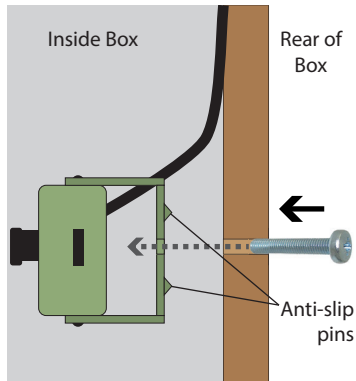



## 4. Configuring Camera Settings

You can configure basic camera settings using the app.

Enter the settings menu while live viewing the camera by tapping the  **Settings icon** in the top-right.

### How to Enable Audio

Go to **Advanced Setting**:  
Toggle on **Audio** and tap **Save**



### How to Sync Time & Date

Go to **General About Device**: Tap **Device Time** & then **OK**

### How to Take a Snapshot



On **Live View**, tap the Snapshot  icon. Then tap the banner that appears that says "...click to share image" to reveal save and sharing options your device.

### How to Save & Share Clips

On **Live View**, tap the **Scissors**  icon. Allow at least four seconds of video to record. Tap the  icon again to stop capturing the video. Tap the banner that appears that says "...click to share video" to reveal save and sharing options your device.

## 5. Installing PC Software



You can also watch the camera on your computer using the free Gamut software.

  Download and install the software from this link:  
<https://bit.ly/GamutCMS5>

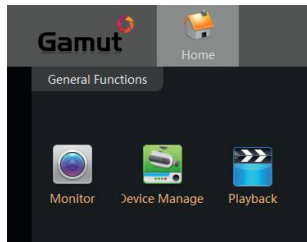
- ✓ Once installed, find and run **CMS5**. Click **Login**.
- ✓ Select **Device Manage** 
- ✓ Find your camera in the list and select the ✓ tick box.
- ✓ Click **Add**.



 If you have set a password, click on the pencil icon on the right and enter it here.

- ✓ Now head back to the **Home**  menu and open **Monitor** .
- ✓ Find your device on the right and double-click.
- ✓ Now the live stream should appear.
- ✓ You can watch back recorded footage using the **Playback** section.

### Using a Mac?

Please visit our help site to find out how to install the **VMS** software.

 [green-feathers.co.uk/help](https://green-feathers.co.uk/help)

## 6. Accessories

If you have accessories, now is the time to install them.

### Boost the Light in your Nest Box

Your camera's night vision helps to improve the picture at night but you can also benefit from adding an extra light source to improve daytime images. Use one of our energy-efficient LED lamps to help with this.

Our daylight lamps automatically switch off at night to ensure the birds are not disturbed and get a good night's sleep. They provide extra light during the day to boost your camera image's vibrancy and exposure.

**When using this camera kit you need to run a separate power supply for the lamp, unless you are powering the camera using a 12V power supply.**

**Need a Daylight LED Lamp?**

 Search on our website for **BBLED3GB**.

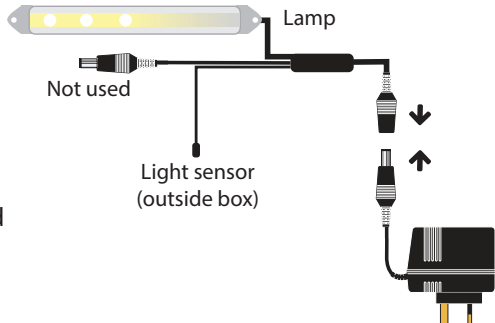

# 7. Troubleshooting

Having trouble? Here are some answers.

## **My camera feels warm**

During operation it is entirely normal for the camera feel warm to the touch.

## **Help! I can't add the camera in the app.**

Please visit our [green-feathers.co.uk/help](https://green-feathers.co.uk/help) for the latest guides on adding the camera to the app on your device(s).

## **The live stream is poor quality**

By default the app starts the live stream in low quality to save bandwidth and for a smoother experience. In the app live stream, you can tap on the icon that says SD and HD or UHD to toggle between qualities.

## **I can't hear any audio on the livestream/recordings.**

First, make sure audio is enabled (see page 9). Then on the app live video you need to switch on audio monitoring by tapping the speaker icon. On the PC software it is a headphones icon.

## **I get black & white images during the day**

This indicates that there is not enough light in your nest box and so the camera is not disengaging night vision mode. Consider using one of our Daytime LED lamps (see page 11).

## **I can't view my recordings on my computer.**

If you are trying to playback recordings from the microSD card on your computer, we recommend the free and open source VLC Media Player, which can be downloaded online.

## Need more help?

If you require more assistance setting up your bird box camera or you need further support then please **head to our Help website** where you'll be able to find all our support guides and videos.

**Find more help online.**

 [green-feathers.co.uk/help](https://green-feathers.co.uk/help)

# FAT BALL CAKES

Something fun for a Saturday afternoon to attract wildlife into your garden. Great in winter when food is scarce. Productive, enjoyable and most of all cheap!

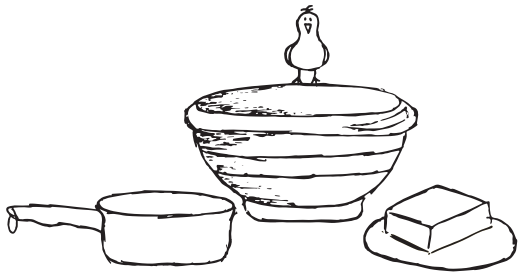

## Types of Container

- Yoghurt pots
- Coconut shells
- Small plant pots
- String
- Lollipop sticks or twigs

## Ingredients

- Lard or suet
- Bird seed
- Porridge oats
- Peanuts (suitable for birds)
- Raisins
- Kitchen scraps

## Equipment

- Mixing bowl
- Saucepan
- Mixing spoon
- Cling film
- Bowl of cold water
- Rubber gloves (optional)

## Method

1. Melt the lard/suet into the saucepan, don't let it burn
2. Once melted, put all dry ingredients into a mixing bowl and then add the lard/suet. If you are going to mix everything together using your hands then make sure that the fat has cooled down enough before you get your hands stuck in!
3. Preparing the containers. Now you have the mixture ready, get a piece of string and loop it and tie a knot in the end of it. Remember not to make the loop too small such that it won't fit over the branch/hook etc.
4. Press the soft mixture into the yoghurt pot/chosen container and around the string, making it as compact as possible so that the string doesn't escape.
5. Once filled to the top of the yoghurt pot, leave the mixture to cool. Storing in a cold shed or garage would be ideal, you could just as easily store them in the fridge.
6. After the mixture is chilled, you need to remove it from the container. The best way to do this is to partially fill a bowl with warm water and place the container in. This way the water will warm the fast slightly in order to soften it allowing you to remove the fat balls.

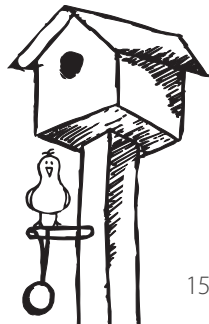

For more help visit:  
[green-feathers.co.uk/help](http://green-feathers.co.uk/help)

