

iQparts
IQ-PARTS-SHOP.COM



**SPECS &
INFORMATION**

ASFA L (9 mm) Hose Clamp AISI 430 Stainless Steel - W3



W3

Thanks to the exclusive design of the housing and the high-strength screw, the ASFA LW3 hose clip has excellent performance while being at the same time very compact.

The cold-formed stamped 9mm band, smoothed on the underside, combined with the bevelled band edges protects the hose from any damage. This clamp is especially indicated for use in the automotive sector.

DIN 3017. The ASFA LW3 hose clip complies fully with the DIN 3017 norm and also with the directive EU 2002/95/EC.

** The maximum application pressure can vary depending on the type of hose used and the geometry of the coupling.*

Application Ø										
mm	Part nº	L max.	S +0,10	h max.	a +0,3 a -0,2	b max.	Maximum values		Box Quantity (MOQ)	Outer Packing
							Torque (Nm)	Pressure (Bars)		
8-16	0301601-4	22,1	0,65	10,5	9	14	3	40	200	800
12-22	0301602-2	22,1	0,65	10,5	9	14	3	40	200	800
16-27	0301603-0	23,6	0,75	10,5	9	14	3,5	38	200	800
20-32	0301604-9	23,6	0,75	10,5	9	14	3,5	36	200	800
25-40	0301606-5	25,6	0,75	10,5	9	14	4	32	100	400
30-45	0301607-3	25,6	0,75	10,5	9	14	4	28	100	800
32-50	0301608-1	25,6	0,75	10,5	9	14	4	24	100	800
40-60	0301609-0	25,6	0,75	10,5	9	14	4	19	100	400
50-70	0301610-2	29,6	0,75	10,5	9	14	4	17	100	100
60-80	0301611-0	29,6	0,75	10,5	9	14	4	15	100	100
70-90	0301612-9	29,6	0,75	10,5	9	14	4	13	50	400
80-100	0301613-7	29,6	0,75	10,5	9	14	4	11	50	400
90-110	0301614-5	29,6	0,75	10,5	9	14	4	10	25	200
100-120	0301615-3	29,6	0,75	10,5	9	14	4	9	25	200
110-130	0301616-1	29,6	0,75	10,5	9	14	4	8	25	200
120-140	0301617-0	29,6	0,75	10,5	9	14	4	7	25	200
130-150	0301618-8	29,6	0,75	10,5	9	14	4	6	25	200
140-160	0301619-6	29,6	0,75	10,5	9	14	4	5	25	25

** It is recommended to apply 75% of the maximum values contained in the table.*

TECHNICAL INFORMATION	
MATERIAL	BAND AND HOUSING: STAINLESS STEEL X6Cr17(AISI-430) SCREW: STAINLESS STEEL (AISI-304 CU)
FINISH	STAINLESS STEEL
CORROSION RESISTANCE	200 HOURS SALT SPRAY (ASTM B-117)
MAXIMUM TIGHTENING SPEED (RPM)	540 ±5

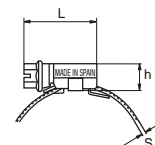
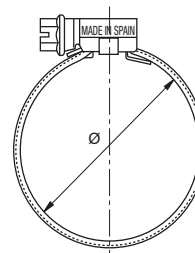
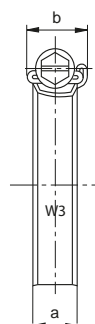
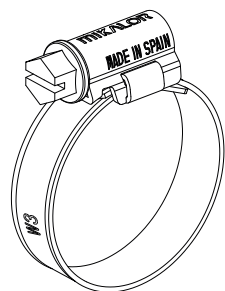



info@iq-parts.nl
Harsweg 34A
2461 EZ Ter Aar
T +31 252 624 126
The Netherlands