

iQparts
IQ-PARTS-SHOP.COM



**SPECS &
INFORMATION**

TOOL CLIPS



①

① Closed Type

Closed Clips are produced in high quality spring steel. They are produced according to industrial and professional users' demands but are also frequently used in the DIY sector. The closed type is our most popular clip.

Three surface finishes are available:

- Standard – Zinc plated (5 µm)
- Black Nylon coated
- White Nylon coated

Dimensional allowance should be made for a reduction in hole size due to the nylon coating.



②

② Open Type

Tool Clips are produced in high quality spring steel. The open type allows an easier entry or withdrawal from the item being secured.

Three surface finishes:

- Standard – Zinc plated (5 µm)
- Black Nylon coated
- White Nylon coated

Dimensional allowance should be made for a reduction in hole size due to the nylon coating.



③

③ Super Clips

Super Clips are the heavy-duty Tool Clips, designed for larger objects up to 93 mm diameter.

Three surface finishes are available:

- Standard – Zinc plated, 5 µm thickness
- Black Nylon coated
- White Nylon coated

Dimensional allowance should be made for a reduction in hole size due to the nylon coating.

Advantages at a glance

- High quality spring steel
- Simple and reliable

Typical applications

- DIY (Do-it-yourself)

Materials

- Standard – Zinc plated, 5 µm thickness
- Black Nylon coated
- White Nylon coated

Dimensions

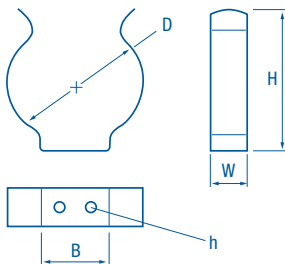
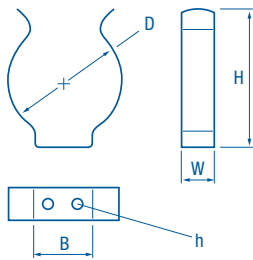
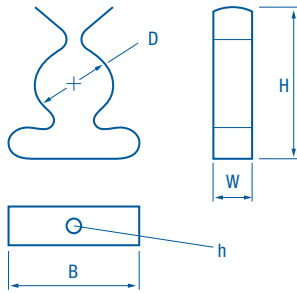

Specifications

TERRY CLOSED CLIP

Diameter ranges (D mm)	Diameter ranges (D in.)	Height (H mm)	Width (W mm)	Breadth (B mm)	Hole (h mm)	Nylon coated (CS70 carbon steel)		
						Product No. Black	Product No. White	Product No. Zinc plated
6-7	1/4-1/4	15.3	6.35	12.9	2.4	0816 5005 006		0816 5009 006
10-12	3/8-1/2	20.0	6.35	15.5	2.4	0816 5005 010	0816 5007 010	0816 5009 010
13-14	1/2-9/16	26.4	7.94	20.1	3.2	0816 5005 013	0816 5007 013	0816 5009 013
16-19	5/8-3/4	32.2	7.94	22.6	3.2	0816 5005 016	0816 5007 016	0816 5009 016
19-21	3/4-13/16	36.4	7.94	25.3	3.2	0816 5005 019	0816 5007 019	0816 5009 019
25-27	1-11/16	40.3	9.52	28.8	3.2	0816 5005 025	0816 5007 025	0816 5009 025
28-31	11/8-11/4	48.7	9.52	34.1	3.6	0816 5005 028	0816 5007 028	0816 5009 028
32-34	11/4-15/16	59.3	11.11	42.8	3.6	0816 5005 032	0816 5007 032	0816 5009 032
38-40	11/2-19/16	67.0	12.70	49.5	4.0*	0816 5005 038	0816 5007 038	0816 5009 038
51-54	2-21/8	80.2	12.70	53.0	4.0*	0816 5005 051	0816 5007 051	0816 5009 051

* 2 holes

TERRY OPENED CLIP

Diameter ranges (D mm)	Diameter ranges (D in.)	Height (H mm)	Width (W mm)	Breadth (B mm)	Hole (h mm)	Nylon coated (CS70 carbon steel)		
						Product No. Black	Product No. White	Product No. Zinc plated
6-7	1/4-1/4	10.5	6.35	3.8	2.4	0816 5004 006		0816 5008 006
10-12	3/8-1/2	13.3	6.35	4.3	2.4	0816 5004 010	0816 5006 010	0816 5008 010
13-14	1/2-9/16	16.1	7.94	5.0	3.2	0816 5004 013	0816 5006 013	0816 5008 013
16-19	5/8-3/4	20.5	7.94	6.5	3.2	0816 5004 016	0816 5006 016	0816 5008 016
19-21	3/4-13/16	26.6	7.94	9.0	3.2	0816 5004 019	0816 5006 019	0816 5008 019
25-27	1-11/16	30.0	9.52	10.2	3.2	0816 5004 025	0816 5006 025	0816 5008 025
28-31	11/8-11/4	33.4	9.52	12.0	3.6	0816 5004 028	0816 5006 028	0816 5008 028
32-34	11/4-15/16	39.0	11.11	12.0	3.2	0816 5004 032	0816 5006 032	0816 5008 032
38-40	11/2-19/16	48.0	12.70	13.0	3.2	0816 5004 038	0816 5006 038	0816 5008 038
51-54	2-21/8	61.3	12.70	19.5	*3.6	0816 5004 051	0816 5006 051	0816 5008 051

* 2 holes

TERRY SUPER CLIP

Diameter ranges (D mm)	Diameter ranges (D in.)	Height (H mm)	Width (W mm)	Breadth (B mm)	Hole (h mm)	Nylon coated (CS70 carbon steel)		
						Product No. Black	Product No. White	Product No. Zinc plated
44-66	13/4-25/8	53.4	12.7	25.5	4.0	0816 6010 044	0816 6011 044	0816 6012 044
64-67	21/2-25/8	75.5	19.1	35.5	4.90	0816 6010 064	0816 6011 064	0816 6012 064
76-79	3-31/8	87.5	19.1	47.0	4.75	0816 6010 076	0816 6011 076	0816 6012 076
89-93	31/2-311/16	101.6	22.2	48.0	4.75	0816 6010 089	0816 6011 089	0816 6012 089



info@iq-parts.nl
Harsweg 34A
2461 EZ Ter Aar
T +31 252 624 126
The Netherlands