

iQparts
IQ-PARTS-SHOP.COM



**SPECS &
INFORMATION**



DuraSeal Exhaust clamp

*Provides a serviceable joint
For high durability requirements*

The simple, effective way to connect exhaust system components. Pipes, mufflers and converters.

*Extra seal and clamp load performance to meet
Or exceed durability requirements without
Permanent distortion to exhaust members.*

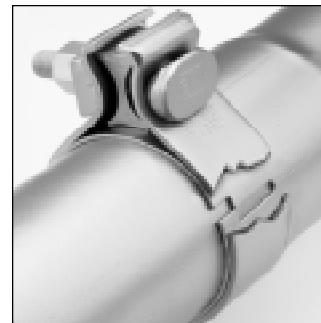
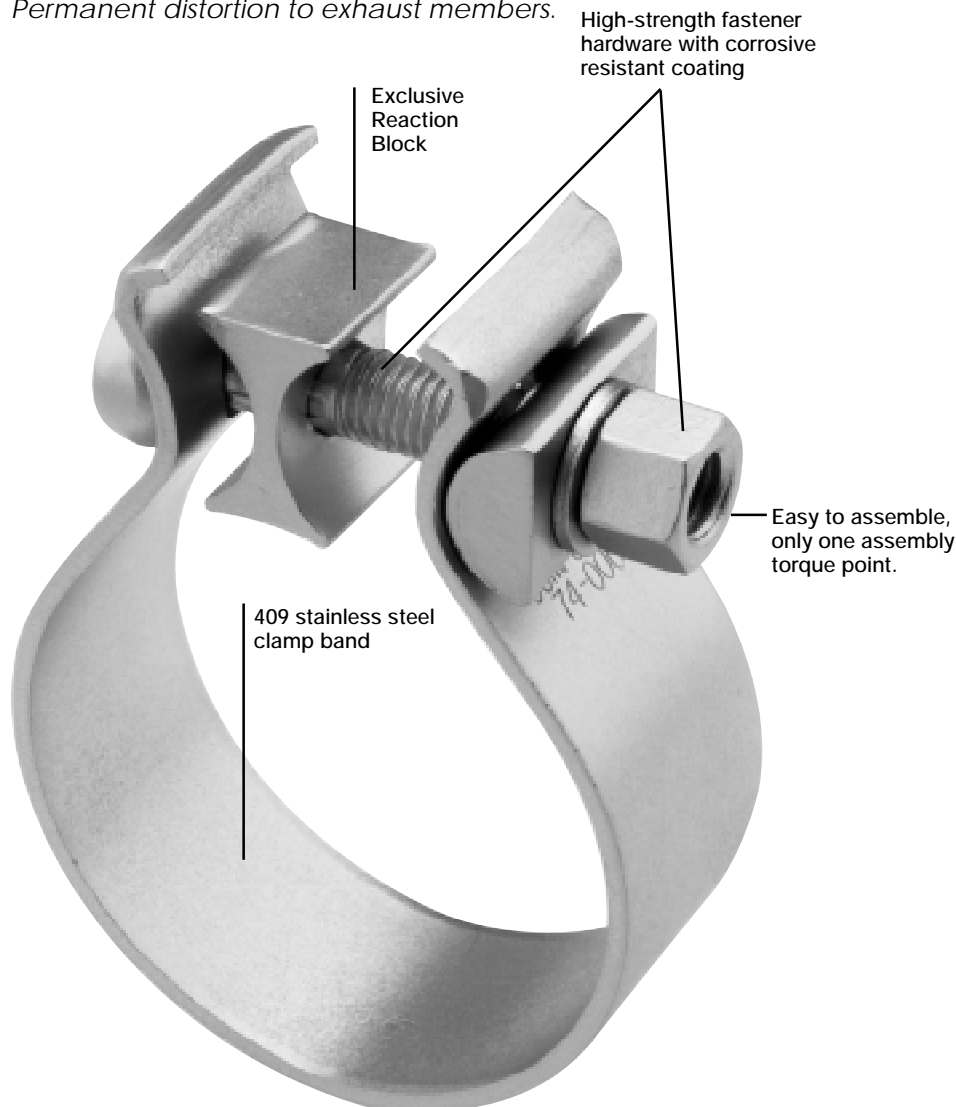

DuraSeal, with Torca designed slots, provides optimal seal and joint retention performance.

- Available in standard size from 50mm (2") to 89mm (3 1/2").
- Improved clamp performance for applications with thicker pipe walls and larger pipe assembly gaps.
- Ideal for applications with limited packaging space. One assembly torque point.
- Unique fastener system efficiently converts band tensile strength into high clamp loads.
- The reaction block provides a full 360° equal distribution of stretching force, prohibiting a pipe distortion while completing a seal around the joined exhaust components.

Unitized assembly . No Loose Hardware. Slides into place, installs easily and reliably.

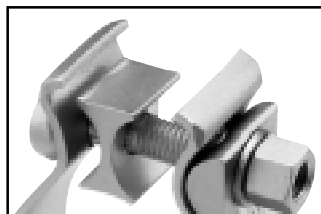

Preattached to outside tube for part-in-assembly shipment to vehicle assembly plant.

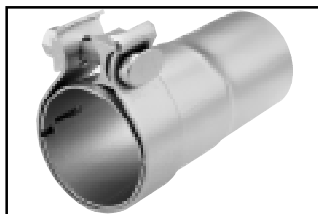

The Reaction Block transfers bolt torque into clamp strength and an assured seal.



Torca Products, Inc.

2430 East Walton
Auburn Hills, MI 48326
(248) 373-4300
FAX: (248) 373-3068

DuraSeal®



Clamp for thicker exhaust pipes or large pipe gap applications.

For Lap Style Joint Connections | Reaction Block Technology | One Torque Point | Pre-Assembled For Easy Installation | Diameter Range 2" – 5"

HEX SCREW DURASEAL

Hex Screw
409 SS Band

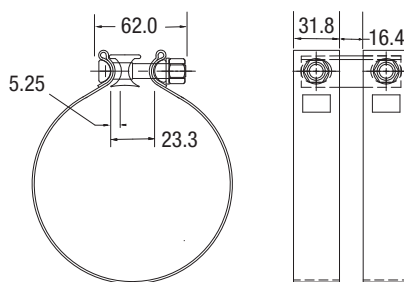

Units: mm



| HEX SCREW DURASEAL | | Band Material | Nominal Joint Diameter | |
|--------------------|---------------|---------------------|------------------------|-------|
| Brand PN | Global PN | | inches | mm |
| 94-0051 | 0371 0001 056 | 409 Stainless Steel | 2 | 50.8 |
| 94-0052 | 0371 0001 062 | 409 Stainless Steel | 2 1/4 | 57.2 |
| 94-0053 | 0371 0003 068 | 409 Stainless Steel | 2 1/2 | 63.5 |
| 94-0054 | 0371 0003 075 | 409 Stainless Steel | 2 3/4 | 69.85 |
| 94-0055 | 0371 0004 081 | 409 Stainless Steel | 3 | 76.2 |
| 94-0056 | 0371 0000 093 | 409 Stainless Steel | 3 1/2 | 88.9 |
| 94-0057 | 0371 0001 107 | 409 Stainless Steel | 4 | 101.6 |
| 94-0050 | 0371 0000 132 | 409 Stainless Steel | 5 | 127.0 |

Note: DuraSeal® connections require 'sized' and slotted pipe. Torca recommends the Torca Seal-Slot design (see below).

Note: Additional sizes are available to meet specific application requirements.

Torca Seal-Slot Lap Style Joint Connection

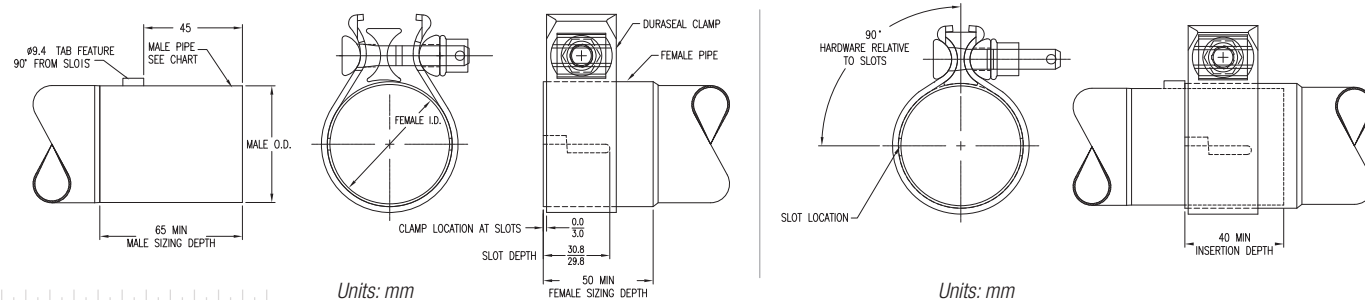

Units: mm

Units: mm



iq
parts
IQ-PARTS-SHOP.COM

info@iq-parts.nl
Harsweg 34A
2431 EZ Ter Aar
T +31 252 624 126
The Netherlands