

## Connecting the ECO-DIM.10 Z-Wave to a Samsung Smartthings HUB

- 1) Make sure you have a Samsung smartthings hub and that you installed it correctly
- 2) Make sure that the ECO-DIM.10 Z-Wave is built-in and connected as described in the dimmer installation manual (included in the dimmer box)
- 3) Make sure the dimmer is turned on (lights are on)
- 4) If you have not yet installed the Samsung Smartthings app, do so. You can download it for free in the Google Play Store or in the Apple App Store
- 5) Create an account and link it to your Samsung Smartthings Bridge
- 6) Open the Samsung Smartthings app and click on the “+” sign

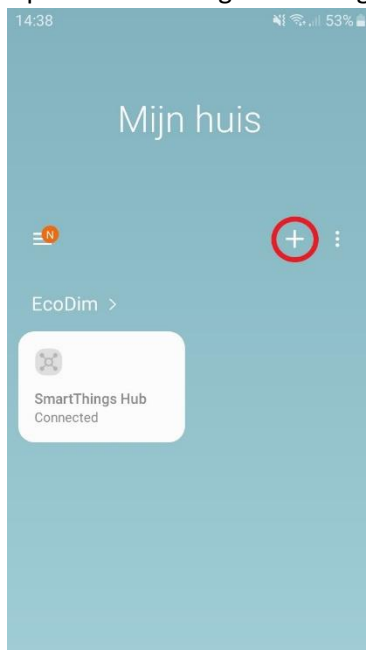

7) Then click on “Device”

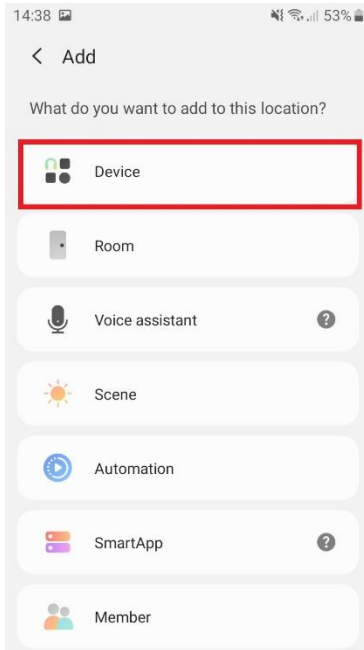

8) Then click on “Generic Z-Wave Device” in the Samsung Smartthings app

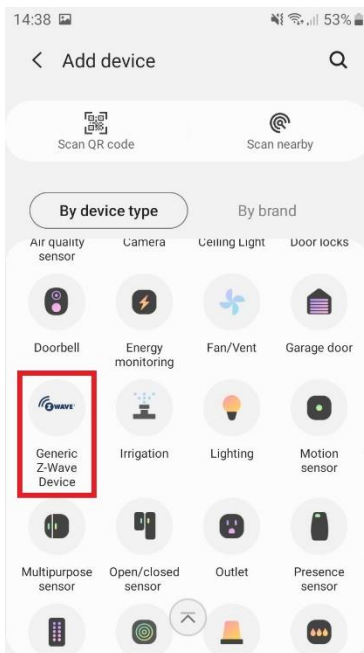

9) Then click on "Z-Wave"

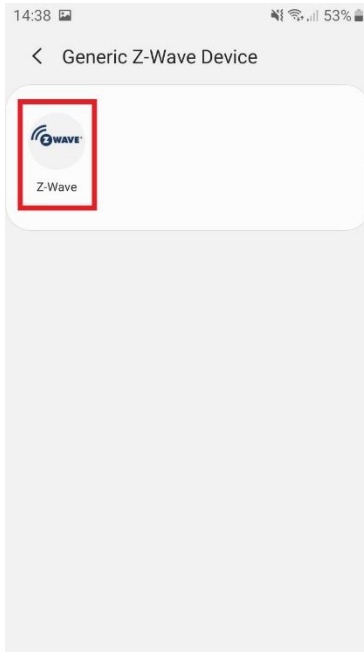

10) Now click on "Generic Z-Wave Device"

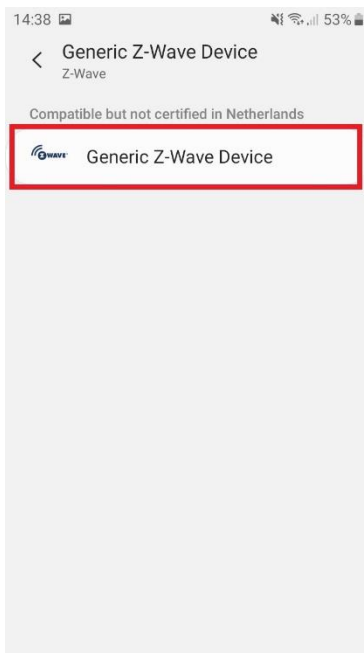

11) In the next screen press "Start"

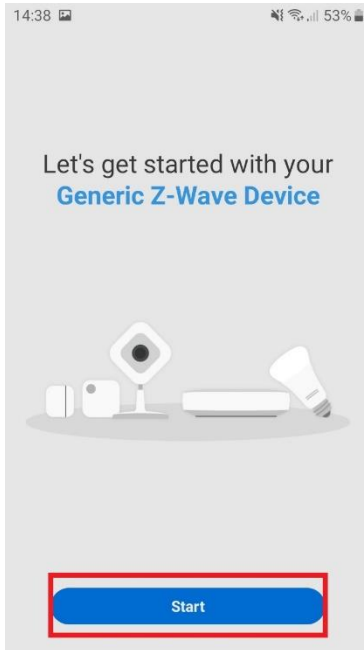

12) Then choose on which Samsung Smartthings HUB you want to install the ECO-DIM.10 Z-Wave and in which room it should be placed. Then click on "Next" at the bottom right

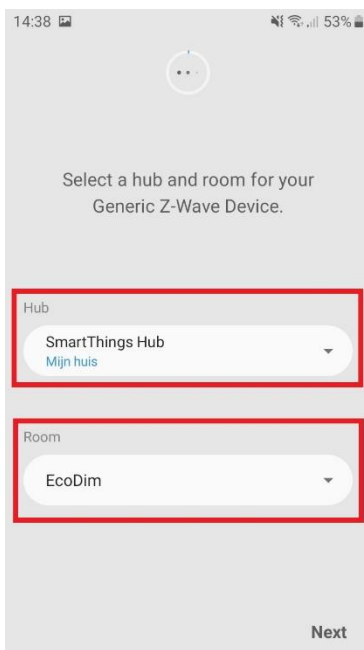

13) Put the ECO-DIM.10 Z-Wave in pairing mode (refer to the supplied manual)

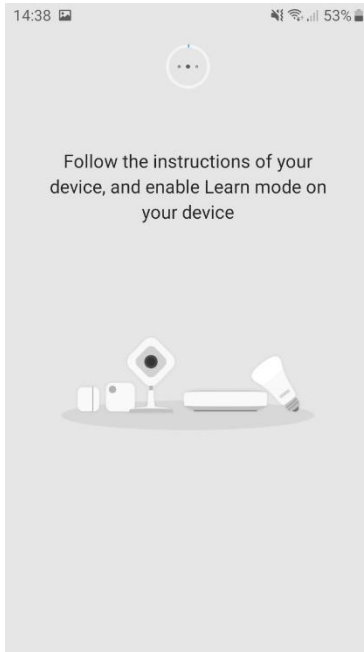

14) The app will then ask you to scan the QR code on the device. You will find this on the back of the ECO-DIM.10 Z-Wave.



15) After this you can give the device a name of your choice. When you return to the home page of the Samsung Smartthings app you will see that the ECO-DIM.10 Z-Wave has been added directly to the chosen room.

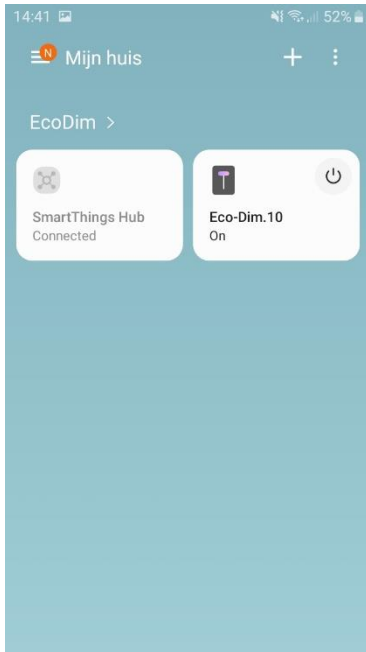

16) You have now completed the installation of the ECO-DIM.10 Z-Wave in the Samsung Smartthings HUB!