

Connecting the ECO-DIM.06 Z-Wave to a Samsung Smartthings HUB

- 1) Make sure you have a Samsung smartthings hub and that you installed it correctly
- 2) Make sure that the ECO-DIM.06 Z-Wave is built-in and connected as described in the dimmer installation manual (included in the dimmer box)
- 3) Make sure the dimmer is turned on (lights are on)
- 4) If you have not yet installed the Samsung Smartthings app, do so. You can download it for free in the Google Play Store or in the Apple App Store
- 5) Create an account and link it to your Samsung Smartthings Bridge
- 6) Open the Samsung Smartthings app and click on the "+" sign

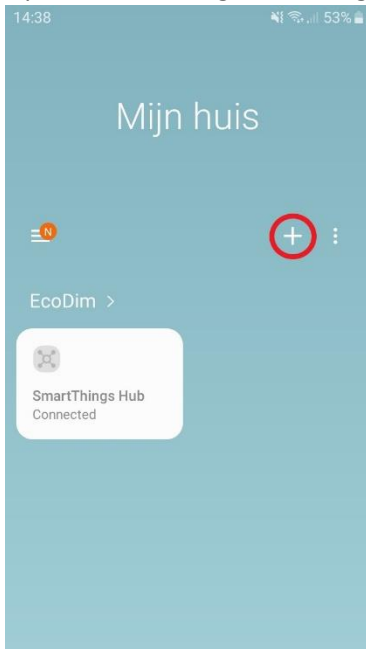

7) Then click on "Device"

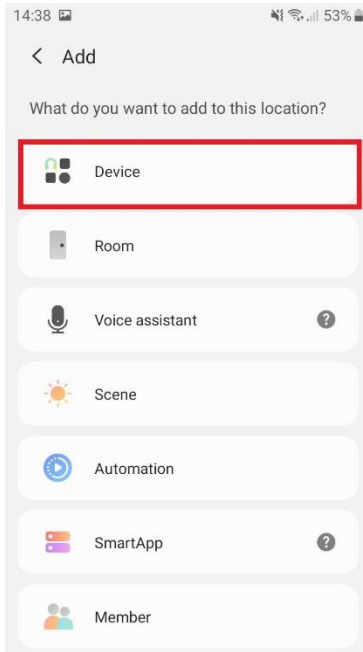

8) Then click on "Generic Z-Wave Device" in the Samsung Smartthings app

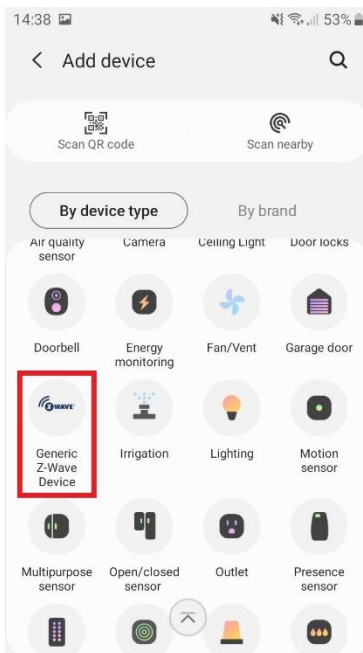

9) Then click on "Z-Wave"

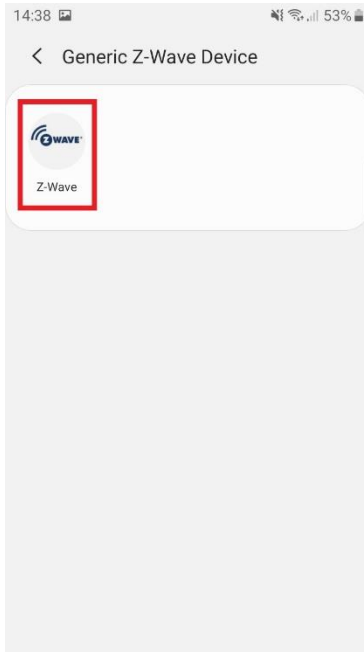

10) Now click on "Generic Z-Wave Device"

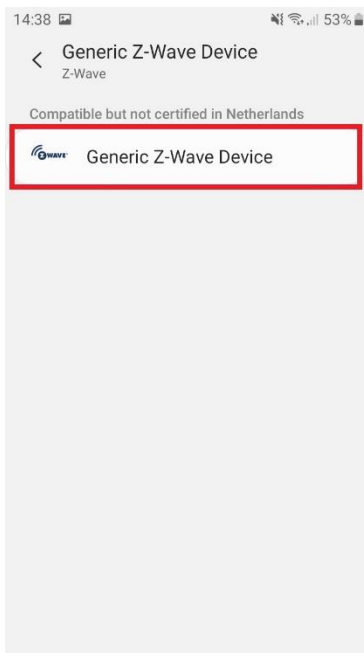

11) In the next screen press “Start”

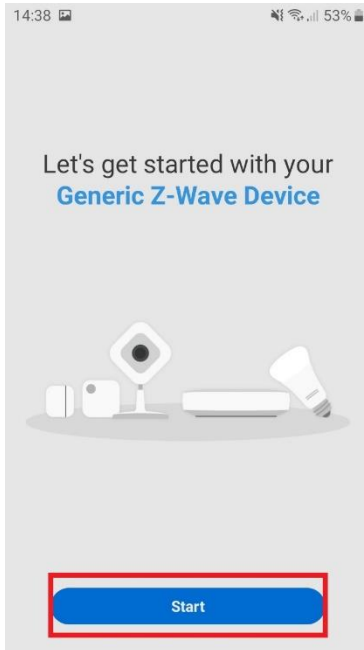

12) Then choose on which Samsung Smartthings HUB you want to install the ECO-DIM.06 Z-Wave and in which room it should be placed. Then click on “Next” at the bottom right

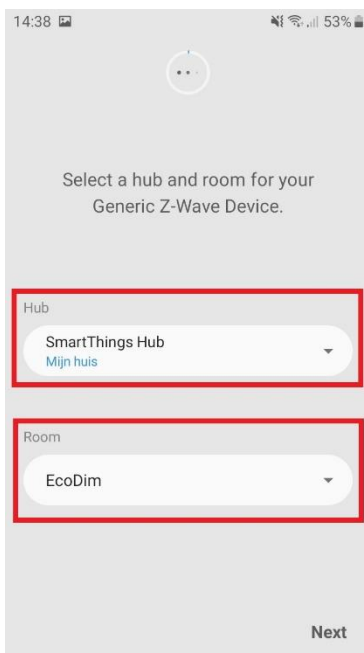

13) Put the ECO-DIM.06 Z-Wave in pairing mode (refer to the supplied manual)

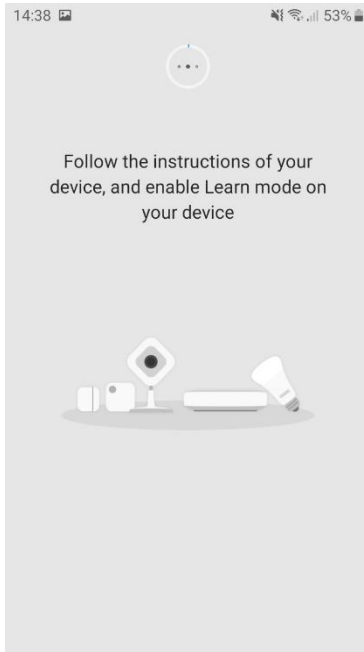

14) The app then asks you to scan the QR code on the device but the plug dimmer does not have a QR code. Click on "Add device manually."



15) Then enter the first 5 digits of the DSK code. You will find this in the manual of the plug dimmer.



16) After this you can give the device a name of your choice. When you return to the home page of the Samsung Smartthings app you will see that the ECO-DIM.06 Z-Wave has been added directly to the chosen room.

17) You have now completed the installation of the ECO-DIM.06 Z-Wave in the Samsung Smartthings HUB!