

# LED TRAFFIC ADVISOR

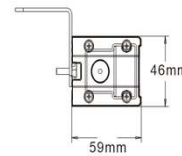
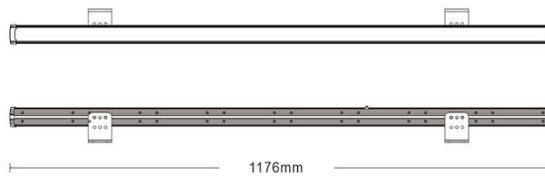

## Specification:

- Voltage: DC 12-24V
- LED qty: 64 pcs
- Flash patterns: 15
- IP rating: IP67
- Temperature: -30°C to +60°C
- Approval: ECE R10, **ECE R65 XA2, SAE J595 Class 1 (Amber)**
- Reverse Polarity Protection
- With memory function
- With synchronization function
- Size(L\*W\*H):1176\*59\*46mm

## Flash Patterns:

#1	Single flash half-half alternately	#9	Double flash
#2	Quad flash half-half alternately	#10	Eight flash head by head alternately
#3	Right arrowstick - fast	#11	Single flash head by head alternately
#4	Right arrowstick - slow	#12	In-out alternately
#5	Left arrowstick - fast	#13	Sides alternately
#6	Left arrowstick - slow	#14	Cycle (#1,11,2,10,12,9)
#7	Middle to side arrowstick - fast	#15	Steady on
#8	Middle to side arrowstick - slow		

## Wiring Options:

### 1. With Controller Box

	ON/OFF (POWER)		Left arrowstick
	Previous pattern		Middle to side arrowstick
	Next pattern		Right arrowstick
	Night mode		Steady on
	Day mode		ON/OFF (An auxiliary device)

### 2. With 7 Wires

RED: + VDC  
 BLACK: - GROUND  
 YELLOW: Pattern Selection  
 .....Apply Yellow to Black  
 .....Less than 1 second for next pattern  
 .....1 to 3 seconds for previous pattern  
 .....3 to 5 seconds back to pattern 1#.  
 .....more than 5 seconds, will reduce brightness.  
 WHITE: Synchronization (2PCS)  
 .....Connect White wires of all heads together for synchronization  
 BLUE: traffic advisor pattern--middle to side arrowstick  
 BROWN: traffic advisor pattern--from left to right  
 GREEN: traffic advisor pattern--from right to left

## Wiring with Auxiliary Device when use controller box:

The current of this device should not exceed 30A.  
 Press the "ALT" button of the controller box can switch on an auxiliary device such as a strobe light, warning beacon, worklamp etc...

### The relay wire connection as below :

- 1.Connect the bar red wire to relay contact 87, and aux device's to contact 30 ;
- 2.Place bar's and aux device's black wires together, and then connect to contact 86;
- 3.Connect the grey wire which is from controller to contact 85;
- 4.Turn on the whole equipment by connecting the power (+) to contact 87.



## Mounting:

- 1.Put the bar on a flat surface, and install the mounting brackets on the back with the hardware as shown.
- 2.Place the bar in the selected location, and mark the hole locations. Adjust the mounting brackets as necessary.
- 3.Drill holes for mounting hardware (user supplied).
- 4.Install the bar with the hardware and attach them firmly so that it cannot be moved or lost.



## WARNING

- ( 1 ) Do not look directly into LEDs while in operation; may cause momentary blindness and/or eye damage.
- ( 2 ) It is not recommended to use magnetically mounted warning devices on vehicles in motion, suggest if need to use available bolt installation on vehicles in motion. Usage is at sole risk and responsibility of the user.