

Drawing



HENDI

Tools for Chefs

Hendi B.V.

Steenoven 21
3911 TX Rhenen
The Netherlands

Batch #

HK 035919 and
up

Appliance part#

212028

Description

Electric Crepe Maker

Date	20-02-2020	Revision #	Revision version
Revision	First bill of materials (BOM)		

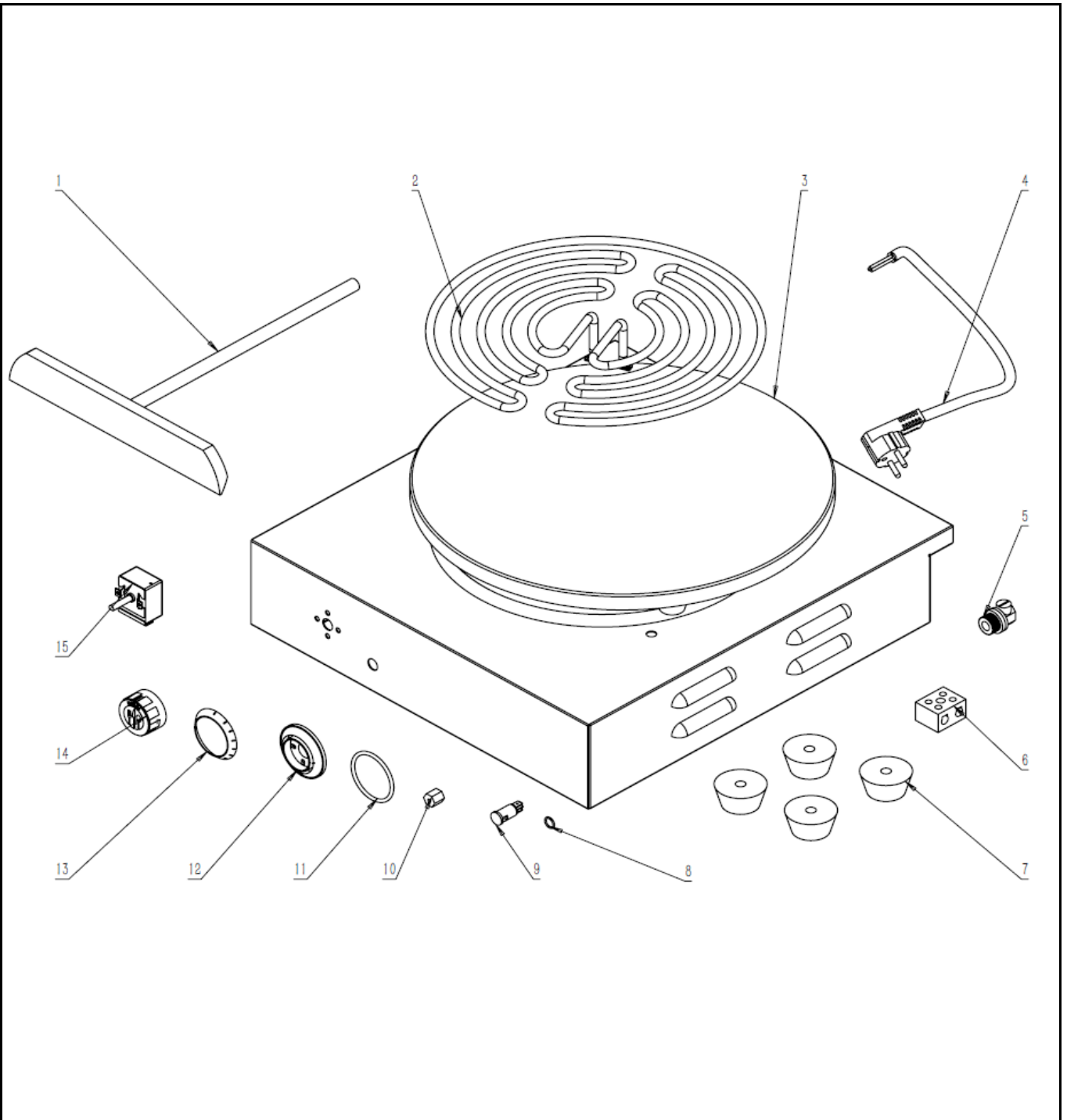

Bill of materials (BOM)

 <b style="font-size: 24px; margin-left: 10px;">HENDI Tools for Chefs Hendi B.V. Steenoven 21 3911 TX Rhenen The Netherlands	Batch #	Appliance part#
	HK 035919 and up	212028
	Description	
Electric Crepe Maker		

Date	20-02-2020	Revision #	Revision version
Revision	First bill of materials (BOM)		

Item	Description	Part#	Quantity	Remark	Picture
1	Wooden scoop	525197	1		
2	Heating element	952191	1		
3	Griddle plate	n/a	1		
4	Power cord	912027	1		
5	Cord inlet with retention	912201	1		
6	Terminal	929940	1		
7	Feet	952207	1	(4pcs in 1 set)	
8	Switch	205426	1		
9	Seal	nss	1	Available as 205471	
10	Indicator light green	205471	1	Incl item 9	
11	Insert knob	nss	1	Available as 952290	
12	Base of knob	nss	1	Available as 952290	
13	Graduation ring of knob	nss	1	Available as 952290	
14	Knob	952290	1	Incl item 11,12, and 13	
15	Thermostat	902011	1		
16	Hendi Badge	n/a	1		
17	Hi-limiter	902004	1		
18	Reset rod	n/a	1		

n/a -> not available

nss -> not sold separately

Circuit diagram

 HENDI Tools for Chefs Hendi B.V. Steenoven 21 3911 TX Rhenen The Netherlands	Batch #	Appliance part#
	HK 035919 and up	212028
	Description	
	Electric Crepe Maker	

Date	20-02-2020	Revision #	Revision version
Revision	First bill of materials (BOM)		

