

# NOP PETIT 1.0

23-Apr.-2019

## 1.0 LED

**LED** 6W | 350mA | COB 3-step | excl. power supply  
 CE <img alt="IP20 symbol" data-bbox="75 220 95 235"/> IP20 <img alt="0.3m symbol" data-bbox="105 220 125 235"/> 0.3m <img alt="31 degree symbol" data-bbox="135 220 155 235"/> 31° <img alt="35/35 degree symbol" data-bbox="165 220 185 235"/> 35°/35° <img alt="355 degree symbol" data-bbox="195 220 215 235"/> 355° <img alt="light icon" data-bbox="205 225 215 235"/>

<img alt="white texture" data-bbox="55 245 75 255"/> white texture (wire springs)	130561W_
<img alt="silver/grey texture" data-bbox="55 255 75 265"/> silver / grey (wire springs)	130561S_
<img alt="black texture" data-bbox="55 265 75 275"/> black texture (wire springs)	130561B_
<img alt="white texture" data-bbox="55 275 75 285"/> white texture (blade springs)	130561W_C
<img alt="silver/grey texture" data-bbox="55 285 75 295"/> silver / grey (blade springs)	130561S_C
<img alt="black texture" data-bbox="55 295 75 305"/> black texture (blade springs)	130561B_C

### LIGHT COLOUR

2700K   >90CRI   560lm   18Vf	3
3000K   >90CRI   580lm   18Vf	5
1800-2700K   >95CRI   350lm   15Vf	9

### ALWAYS USE

for power supplies see our catalogue

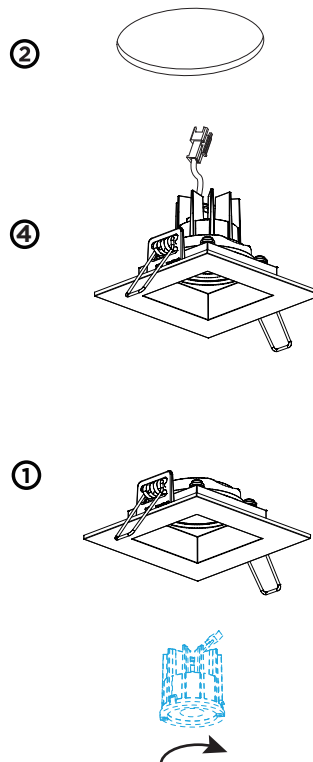

## DIMENSIONS

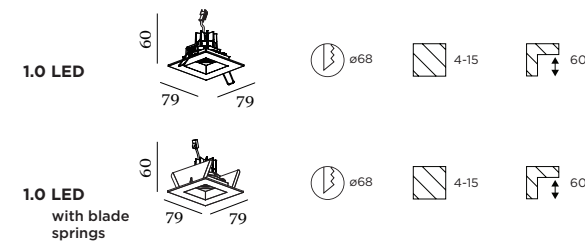

## MOUNTING INSTRUCTION

- Put the LED engine in the fixture and fix it by turning it a half turn.
- Make a hole in the ceiling according to the prescribed dimensions.

## 3 POWER CONNECTION

SERIAL CONNECTION - for LED

**Always use POWER SUPPLY according to the specifications of the LED-module**

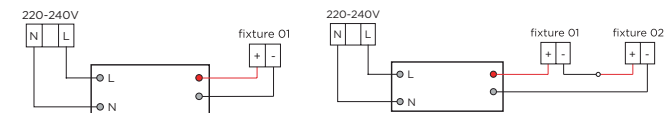

- Push up the springs and insert the fixture in the ceiling hole. Once the springs are in the ceiling let loose of the springs



### CAUTION: NO HOT PLUGGING!

Before connecting the luminaire the converter needs to be disconnected from the power supply. If this instruction is disregarded the luminaire might be damaged or destroyed.