

RON

17-May-2016

1.0 LED

LED 7/10W | 350-500mA | COB 3-step | excl. power supply
 CE P20 960°C 0,3m 35°/35° 355°

white texture	111161W_
black texture	111161B_
white texture (blade springs)	111161W_C

LIGHT COLOUR

2700K >90CRI 420-590lm 18Vf	3
3000K >90CRI 470-640lm 18Vf	5
1800-2850K >90CRI 320-440lm 18Vf	9

ALWAYS USE

for power supplies see our catalogue

1.0 MR16

QR-CBC51 max. 50W | GU5.3 | 12V | excl. transformer
 CE P20 960°C 0,9m 35°/35° 355° DO NOT COVER WITH INSULATION

white texture	111110W0
silver / grey	111110S0
black texture	111110B0
white texture (blade springs)	111110W0C

ALWAYS USE

for transformers see our catalogue

1.0 PAR16

PAR16 max. 50W | GU10 | 220-240VAC | 50-60Hz
 CE P20 960°C 0,9m 35°/35° 355° DO NOT COVER WITH INSULATION

white texture	111120W0
silver / grey	111120S0
black texture	111120B0
white texture (blade springs)	111120W0C

ALWAYS USE

for PAR16 lamps see our catalogue

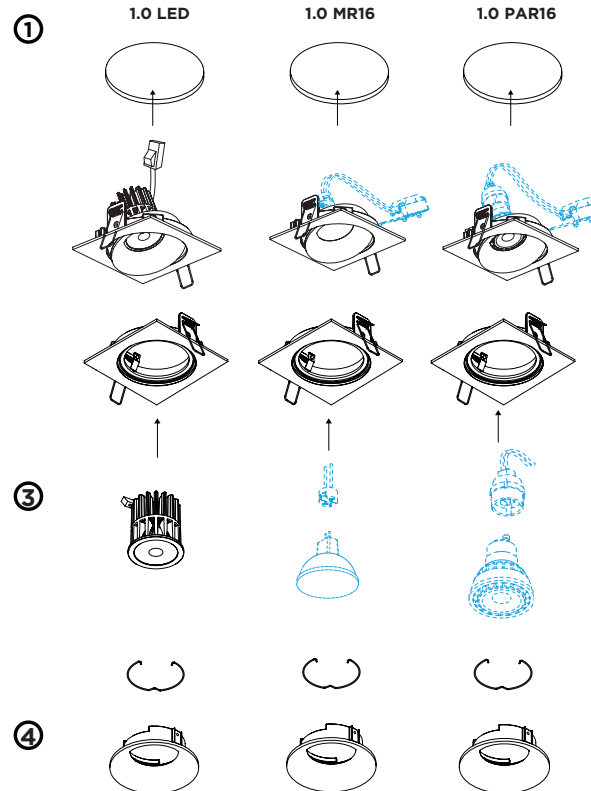

DIMENSIONS

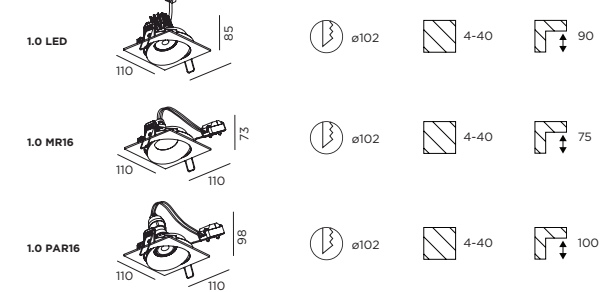

MOUNTING INSTRUCTION

- 1 Make a hole in the ceiling according to the prescribed dimensions.

POWER CONNECTION

- 2 SERIAL CONNECTION - for LED

Always use POWER SUPPLY according to the specifications of the LED-module

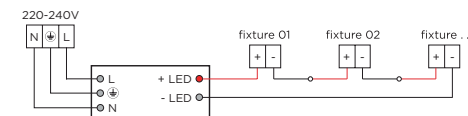

PARALLEL CONNECTION - for MR16

Always use 12V TRANSFORMER

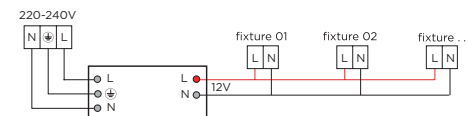

PARALLEL CONNECTION - for PAR16

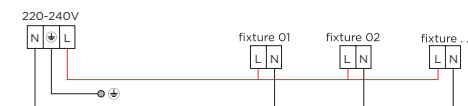

- 3 Insert the lamp into the inner part of the RON
- 4 Click the inner part of the RON into the outer part



WEVER & DUCRÉ
LIGHTING

www.weverducre.com

Wever & Ducre bvba Kwadestraat 153 bus 2.1 8800 Roeselare

**INSTALLATION
INSTRUCTIONS**