

# Dimensions

PN-HW861

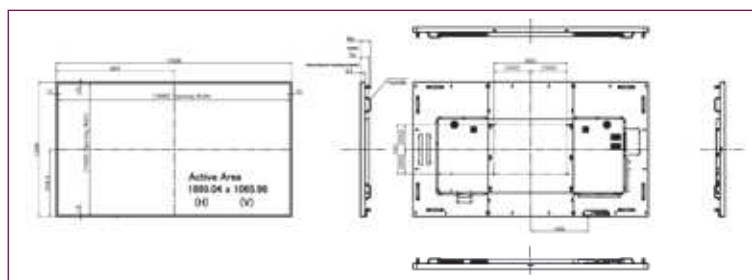

PN-HW751

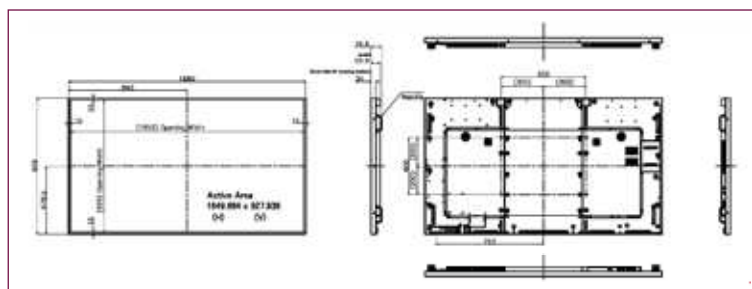

PN-HW651

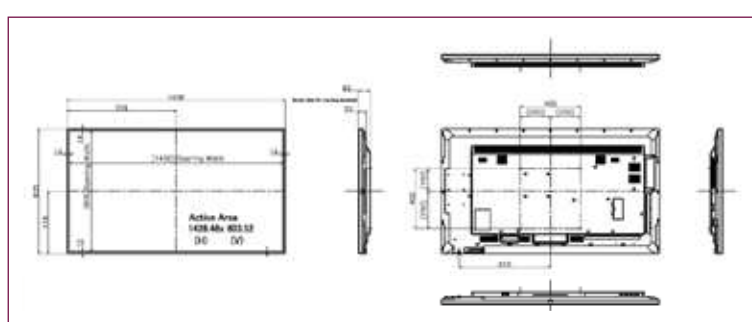

PN-HW551

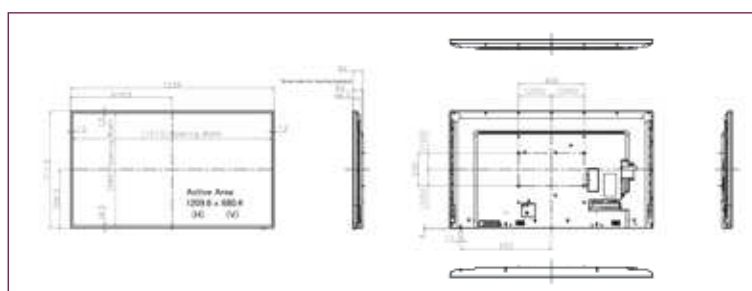

PN-HW501

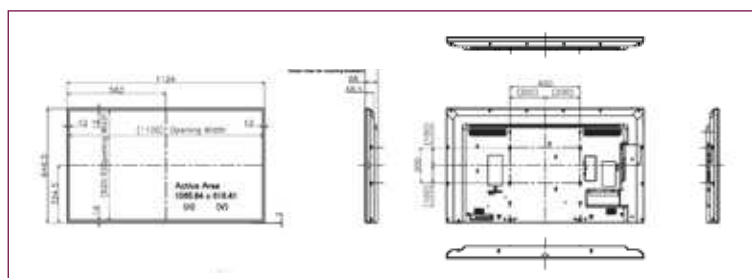

PN-HW431

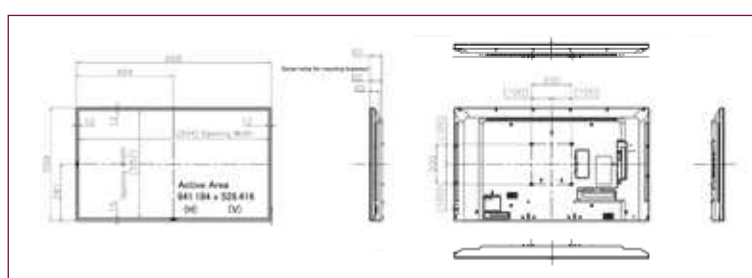

# Specifications

Model name	PN-HW861*1	PN-HW751	PN-HW651	PN-HW551	PN-HW501	PN-HW431	
<b>Installation</b>	Landscape / Portrait						
	86" Class [85 3/8 inch (217.426cm) diagonal] TFT LCD	75" Class [74 1/2 inch (189.273 cm) diagonal] TFT LCD	65" Class [64 1/2 inch (163.896 cm) diagonal] TFT LCD	55" Class [54 3/8 inch (138.783cm) diagonal] TFT LCD	50" Class [49 1/2 inch (125.730cm) diagonal] TFT LCD	43" Class [42 1/2 inch (107.986cm) diagonal] TFT LCD	
<b>LCD panel</b>	<b>Backlight</b>	LED, edge lit		LED, full array			
	<b>Max. Resolution</b>	3,840 x 2,160 pixels					
	<b>Max. Display Colours</b> (approx.)	Approx. 1.07 billion colors					
	<b>Pixel Pitch</b> (HxV)	0.4935 mm (H) x 0.4935 mm (V)	0.429 mm (H) x 0.429 mm (V)	0.372 mm (H) x 0.372 mm (V)	0.315 mm (H) x 0.315 mm (V)	0.2854 mm (H) x 0.2854 mm (V)	0.2451 mm (H) x 0.2451 mm (V)
	<b>Max Brightness**</b>	400cd/m <sup>2</sup>		350cd/m <sup>2</sup>			
	<b>Contrast ratio</b>	1200 : 1		4000 : 1			
	<b>Viewing Angle</b> (H/V)	178°/178° (CR≥10)					
	<b>Active Screen Area</b> (W×H)	1.895.04 x 1.065.96 mm	1.647.36 x 926.64 mm	1.428.48 x 803.52 mm	1.209.6 x 680.4 mm	1.095.84 x 616.41 mm	941.18 x 529.41 mm
<b>Response Time</b>	8ms (grey to grey, avg.)						
<b>Input Terminals</b>		1x Analog Mini D-Sub 15 Pin, 3x HDMI (HDMI2.0, HDCP2.2, HDMI CEC)					
	<b>Audio</b>	3.5mm mini stereo jack x 1					
	<b>Serial</b> (RS-232C)	D-sub 9 pin x 1					
	<b>LAN Terminal</b>	10Base-T/100Base-TX x1					
<b>Output Terminals</b>	<b>USB Port</b>	USB 2.0 compliant (For Media Player) x 1					
	<b>Audio</b>	RCA pin (L/R) x 1					
<b>Plug &amp; Play</b>	VESA DDC2B						
<b>Power Management</b>	VESA DPMS						
<b>Speakers</b>	10W + 10W						
<b>Power Requirement</b>	AC 100-240V, 50/60 Hz						
<b>Mounting</b> (4 points)	600 mm x 400mm pitch, M6 screw		400 mm x 400mm pitch, M6 screw	400 mm x 200mm pitch, M6 screw		200 mm x 200mm pitch, M6 screw	
<b>Environmental Conditions</b>	<b>Operating Temperature</b>	(0°C to 40°C)					
	<b>Operating Humidity</b>	20% to 80% (no condensation)					
<b>Power Consumption</b> (input signal waiting mode / standby mode)	330 W (0.7W / 0.5W)	255 W (0.7W / 0.5W)	205 W (0.7W / 0.5W)	150 W (0.7W / 0.5W)	130 W (0.7W / 0.5W)	115 W (0.7W / 0.5W)	
<b>Dimensions</b>	1.928 x 76 x 1.099 mm	1.680 x 65.5 x 959 mm	1.458 x 82 x 835 mm	1.239 x 62 x 711.5 mm	1.124 x 69 x 646.5 mm	968 x 61 x 559 mm	
<b>Weight</b>	64kg	55kg	27.5kg	16kg	13kg	9 kg	
<b>Main Accessories</b>	AC power cord, remote control unit, battery (AAA size x 2), CD-ROM, set-up manual, cable clamp x 2, logo sticker, USB flash drive cover, USB flash drive cover fixing screw x 2						



\*1 The PN-HW861 is available now and all other models coming later 2019. \*\* Brightness depends on input mode and other picture settings. Brightness level will decrease slightly over the lifetime of the product. Due to the physical limitations of the equipment, it is not possible to maintain a precisely constant level of brightness. HDMI, the HDMI logo, and High-Definition Multimedia Interface are trademarks or registered trademarks of HDMI Licensing, LLC in the United States and other countries. All other brand names and product names may be trademarks or registered trademarks of their respective owners. All trademarks acknowledged. E&OE. Sharp Corporation November 2018. Ref: 19484 Amber 8pp Brochure.