

## IMABEL decking Installation Guide

---

**Tecos Europe NV** presents its range of terrace flooring with **IMABEL** decking. **IMABEL** decking is made from 50% wood and 50% PVC.

By mixing these two raw materials into a single product, you have the benefits of low-maintenance PVC and the natural, warm appearance of wood. **IMABEL** offers you all these benefits in one product.

The terrace boards are water-resistant, shatterproof, resistant to insects and easy to install. Your terrace forms a harmonious whole to enjoy for many years to come.

### Basic guidelines:

1. Read this guide carefully before starting to install your **IMABEL** terrace.
2. **IMABEL** decking is wrapped in a non transparent film at delivery. Please leave this film around the pallet as long as possible during storage. If not, put the **IMABEL** boards and skirting out of sun- and daylight.
3. Before installing the terrace, it is important to allow the boards to acclimatise for at least 48 hours. Lay the boards out of sunlight or rain on supporting beams that are on a flat base, at intervals of not more than 1 metre.
4. If you keep the boards for more than 48 hours, you should store them indoors.
5. The boards should always be handled by two people.
6. The boards are transported horizontally.
7. Installation should not be carried out if the outside temperature is below 0°C.
8. **IMABEL** terrace boards must not be viewed as a structural base. When laying terrace boards in galleries, staircases, balconies, etc. (this list is not exhaustive) specific precautions must be taken to comply with the applicable standards.
9. **IMABEL** terrace boards may not be glued.
10. **IMABEL** terrace boards are designed for a maximum even load of 1400 kg/m<sup>2</sup>.
11. The maximum concentrated load on 1 board is 100 kg.
12. The design of **IMABEL** terrace boards is not suitable for cars, horses, carts, etc. (this list is not exhaustive).
13. Use **IMABEL** accessories when installing **IMABEL** terrace boards.
14. Gradations of colour are inherent to the product.
15. Allow for an initial expansion of at least 4 mm/m when determining the necessary expansion joints. The joints will shrink over time (one year).
16. For terraces more than 12 m in length we recommend splitting the terrace into separate modules.
17. Pre-drill whenever you have to drill holes. This will make installation easier.
18. Slight discoloration is an inherent characteristic of the product. It may not therefore be used against Tecos.
19. The profiles can exhibit a yellow colour effect several hours after placing the terrace boards. This process is inherent to the product. Do not worry, this yellow colour disappears after a few days. The profiles get back their natural beautiful color.

## Tools

IMABEL provides you with the following:

**IMABEL** terrace board, **IMABEL** skirting, **IMABEL** substructure, **IMABEL** connecting clips with screw, **IMABEL** start- and end-clips with screw

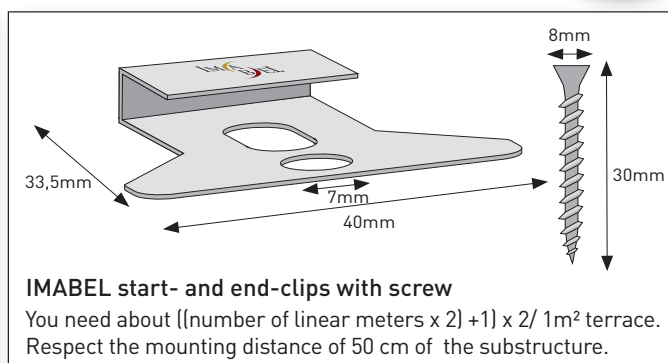
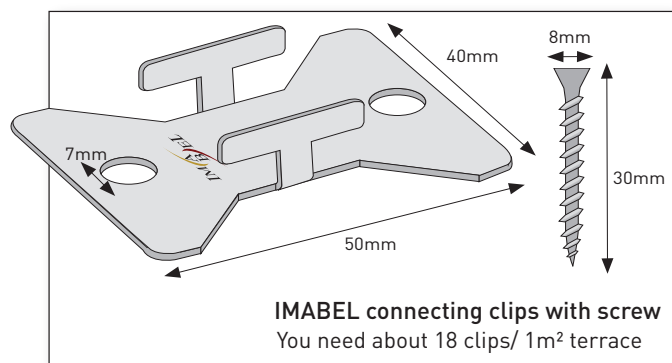
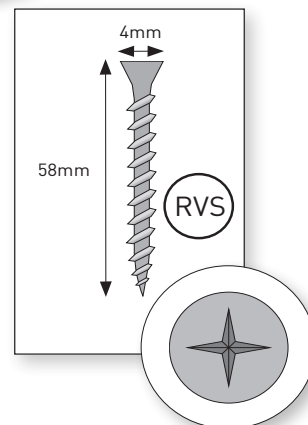
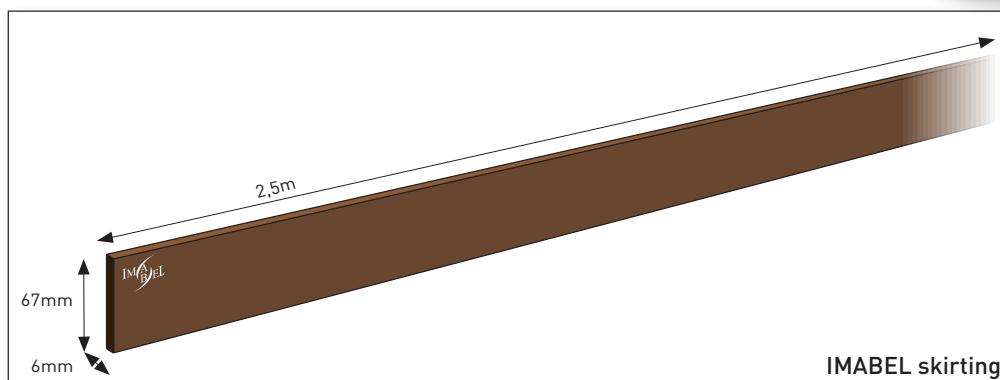
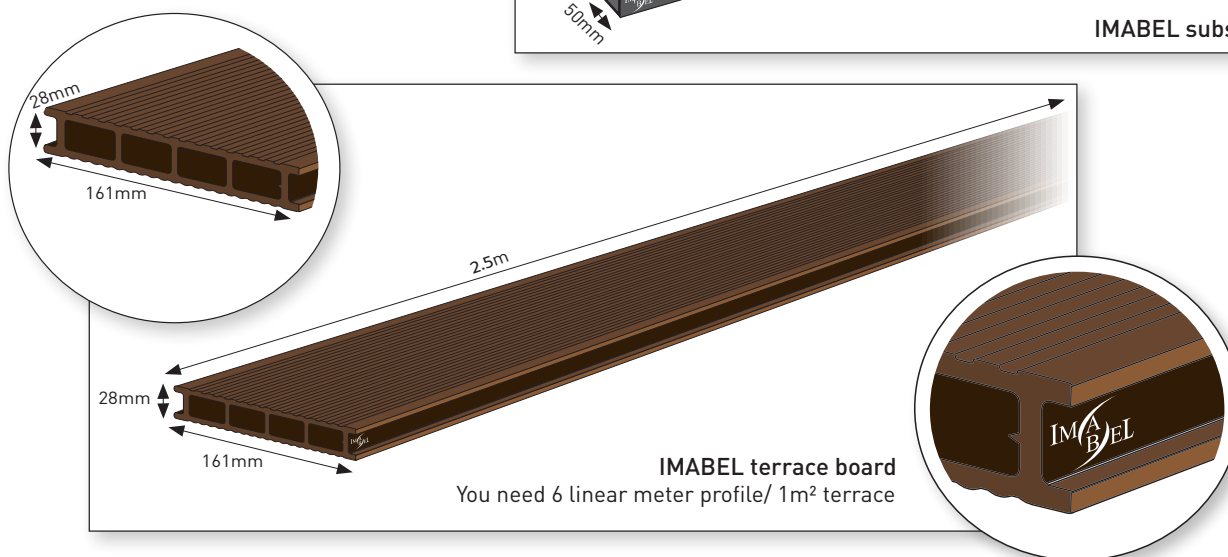
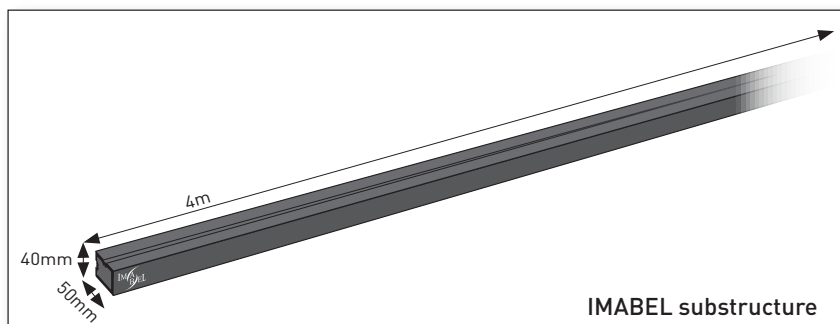

To install your terrace accurately and correctly, you will need the following tools:

Spirit level, tape measure, cross-cut saw, fretsaw, drill, screwdriver with depth limiter, plastic hammer.

### **Base (Drawing 1)**

- Make sure the base is flat and stable, with a gradient of 10 mm per metre along the length of the drainage, in other words along the length of the bearers (away from the wall). The base must be solid (concrete slab, cement, etc.). The quality of the base must satisfy the applicable standards.

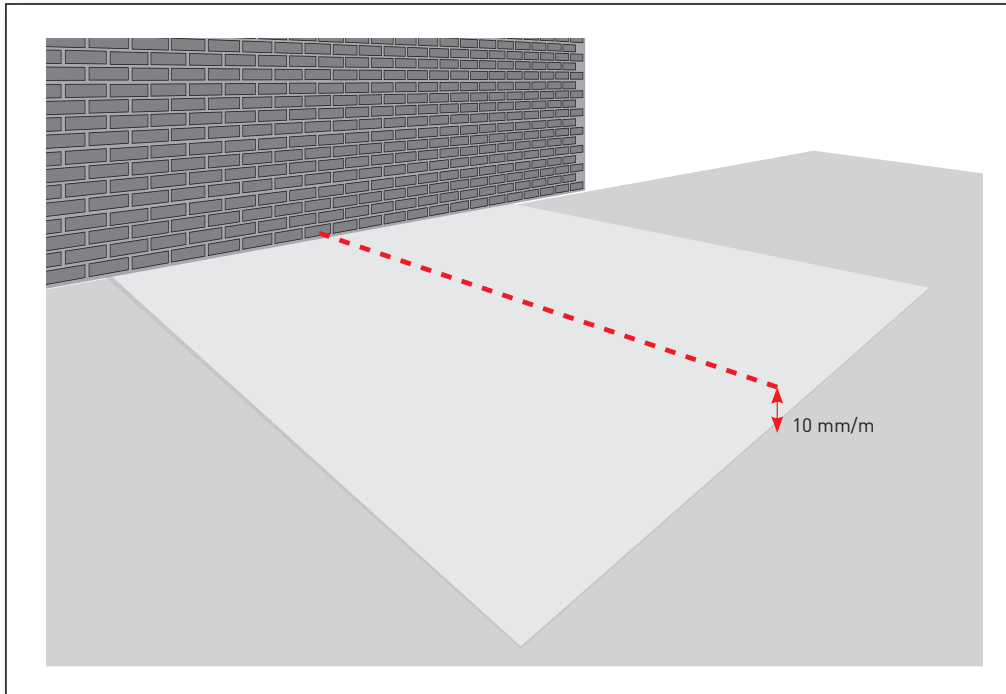

### **Substructure: (drawing 2)**

- Use the IMABEL substructure with dimensions 40 x 50 x 4000 mm. If you want to screw your sub-structure, you must drill larger holes that can provide for the dilatation of the sub-structure.

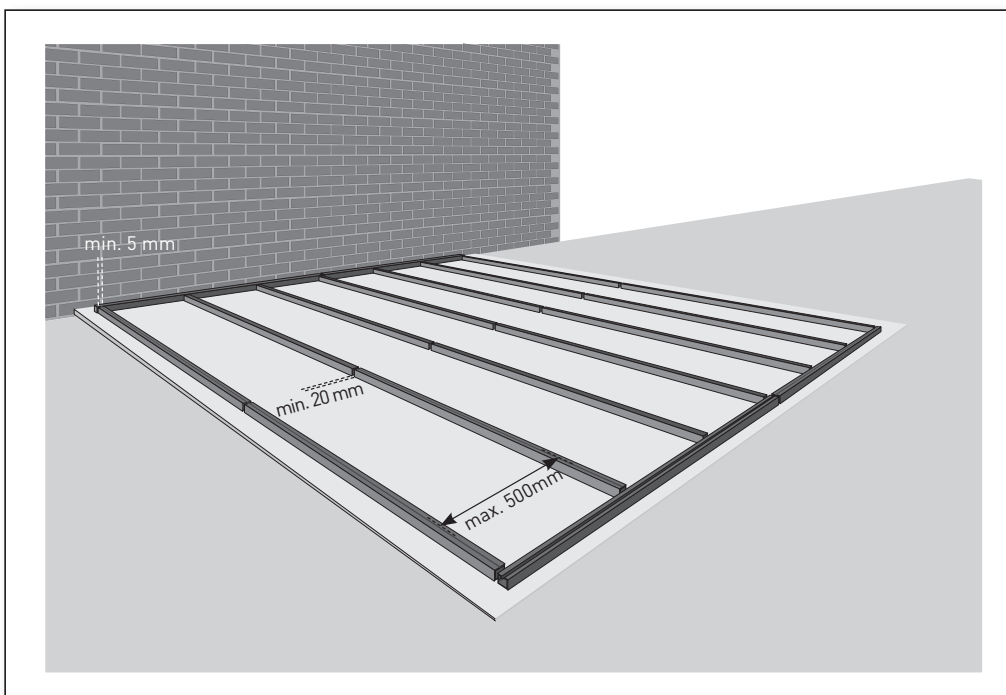

The terrace boards must be mounted on a **IMABEL** provided substructure. They may not be installed directly onto a flat base for reasons of ventilation and water management.

The supporting **IMABEL** beams must not be seen as a structural base and must be supported over their entire length.

Use at least 3 bearings for each installation.

Each end of a terrace board must be supported by a bearer to prevent deformation due to its intrinsic weight.

It is important that the lattice forms a single whole. If the supporting beams cannot be secured to the base, you can fix them to floor beams, which must be positioned at maximum intervals of 500 mm (centre to centre). The floor beams must also be attached to the ground. The lattice must be perfectly level.

The following substructure mounting distances must be respected because of the expansion of the material:

- Centre-to-centre distance of 500 mm between bearers.
- Leave joints of 20 mm between bearers lengthwise for efficient drainage.
- Leave at least 5 mm between bearers and walls

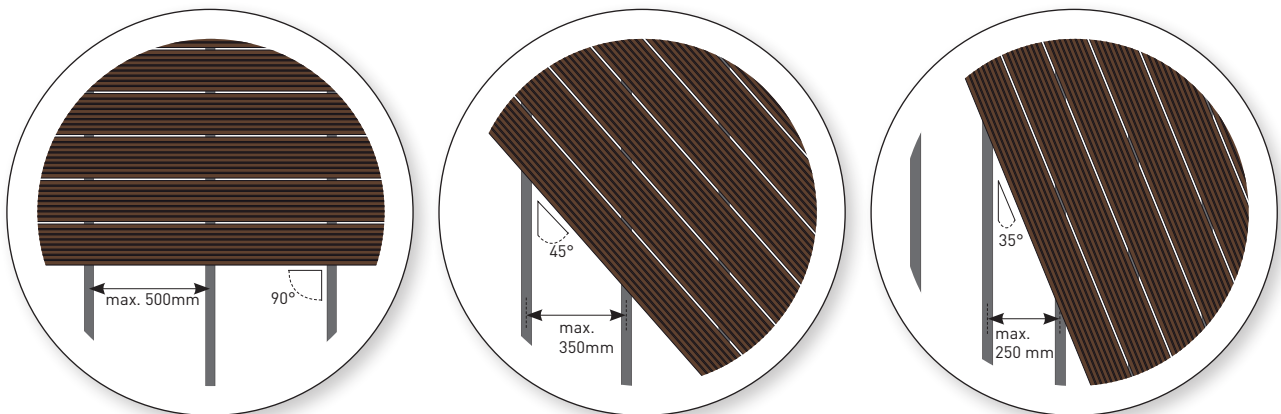

The mounting distances between bearers change if you lay terrace boards at an angle



## Mounting terrace boards on the substructure

- Installation of the terrace boards is started and ended with **IMABEL** start- and end-clips. Pre-drill the bearer and attach start- and end-clips and secure the clips on each bearer (max 500 mm). Clips must not be fitted staggered.  
Slide the first board firmly into the start- and end-clips.

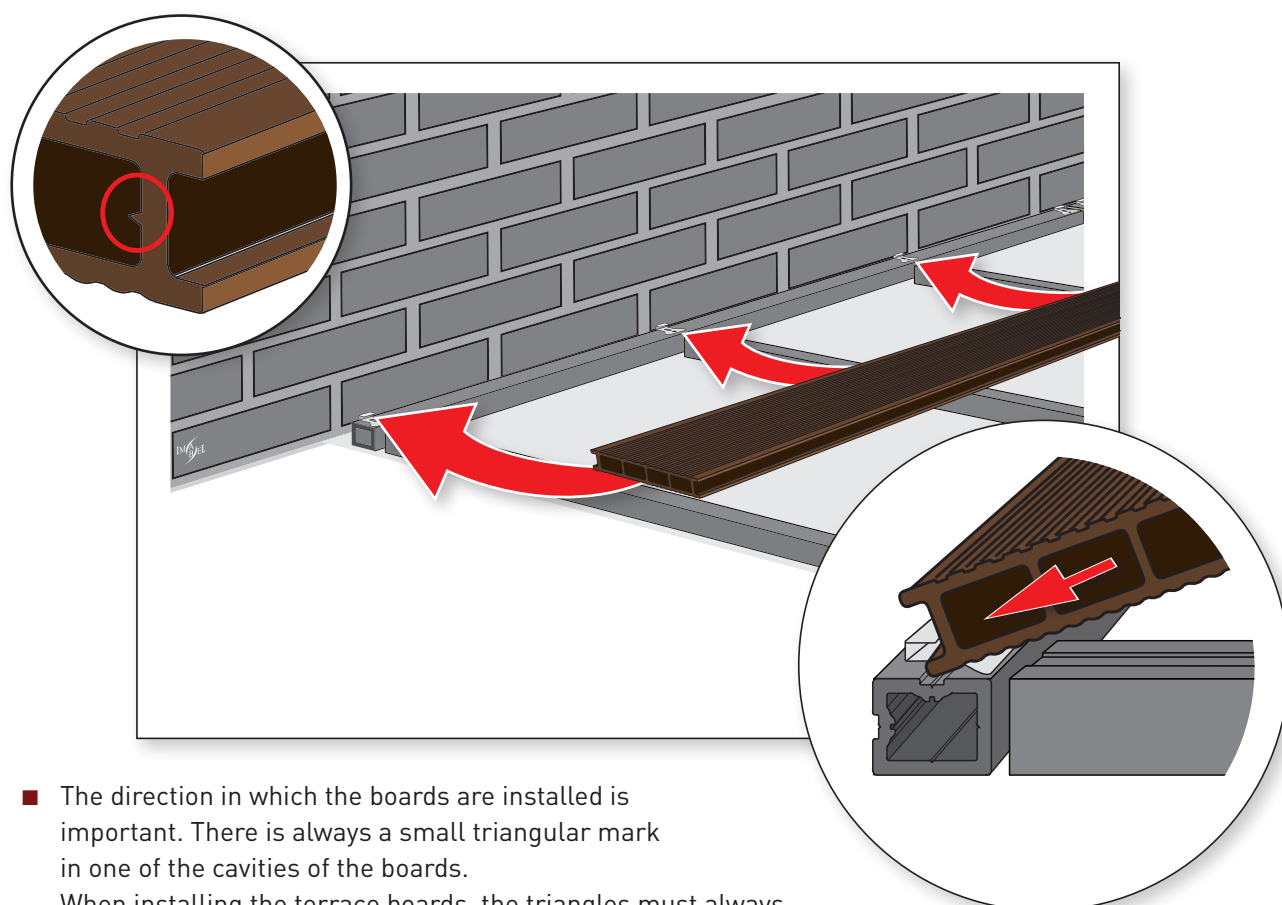
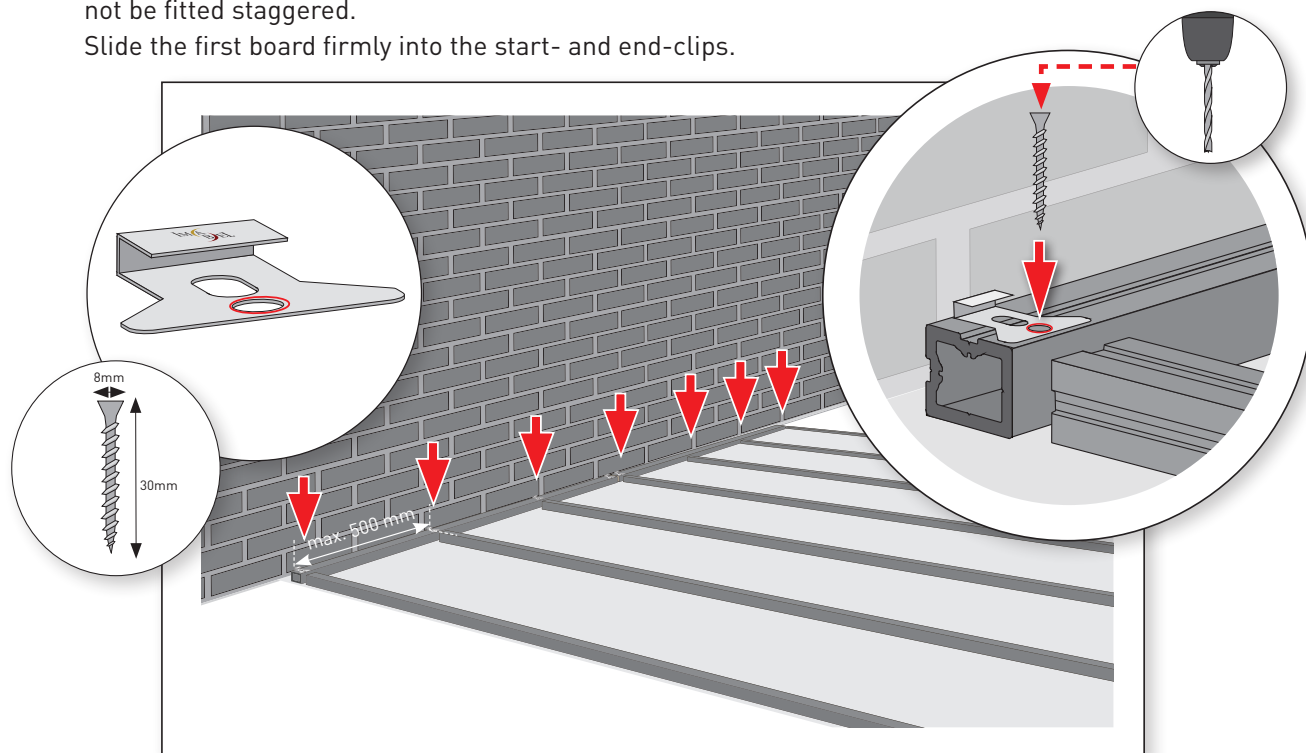

- The direction in which the boards are installed is important. There is always a small triangular mark in one of the cavities of the boards.  
When installing the terrace boards, the triangles must always be installed in the same place so that all boards are installed in the same direction.

- After installing each board, screw the **IMABEL** connecting clips down with the **IMABEL** screws provided. Use one screw per **IMABEL** clip.  
The boards are secured to each bearer with an Imabel connecting clip. Connecting clips must not be fitted staggered.

**IMABEL** connecting clips are used to determine the correct distances between terrace boards, allowing for the expansion of the material.

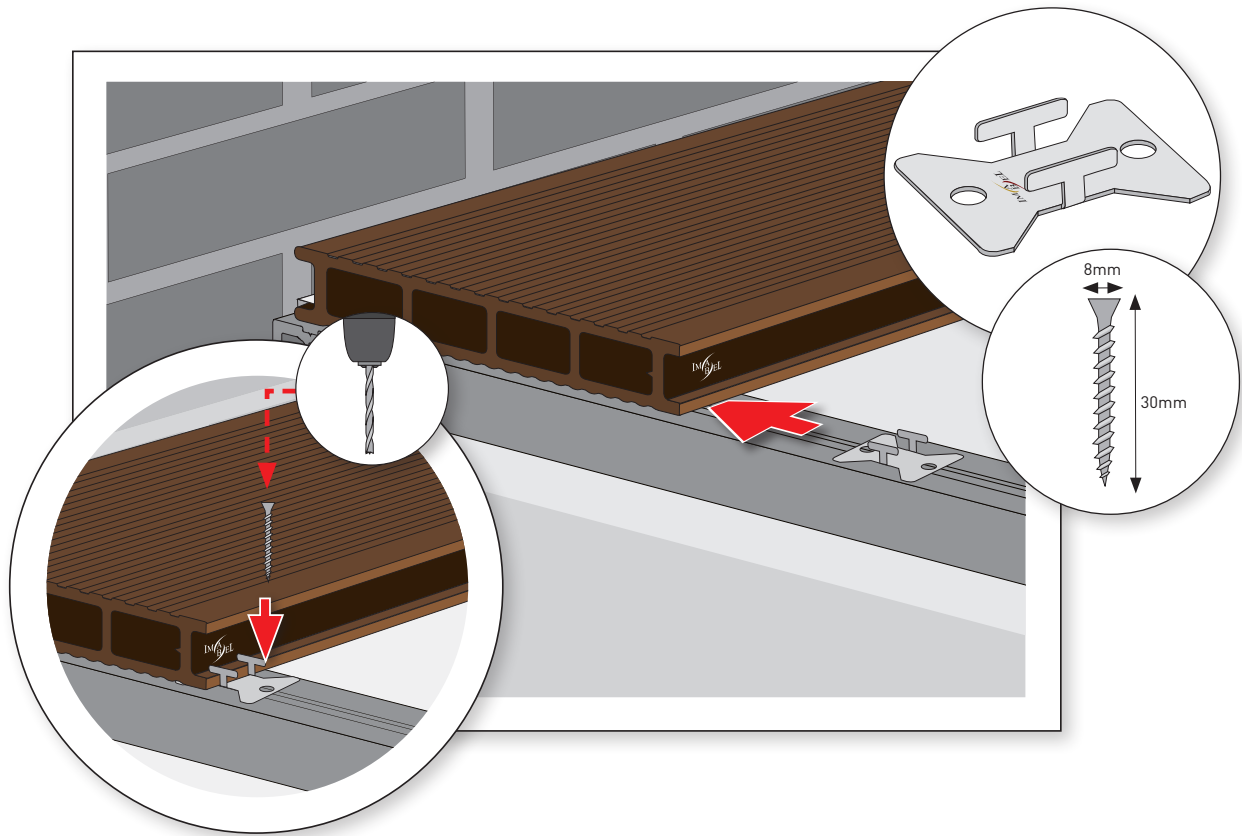

- The terrace must end with a complete terrace board or with the cutting sizes below.

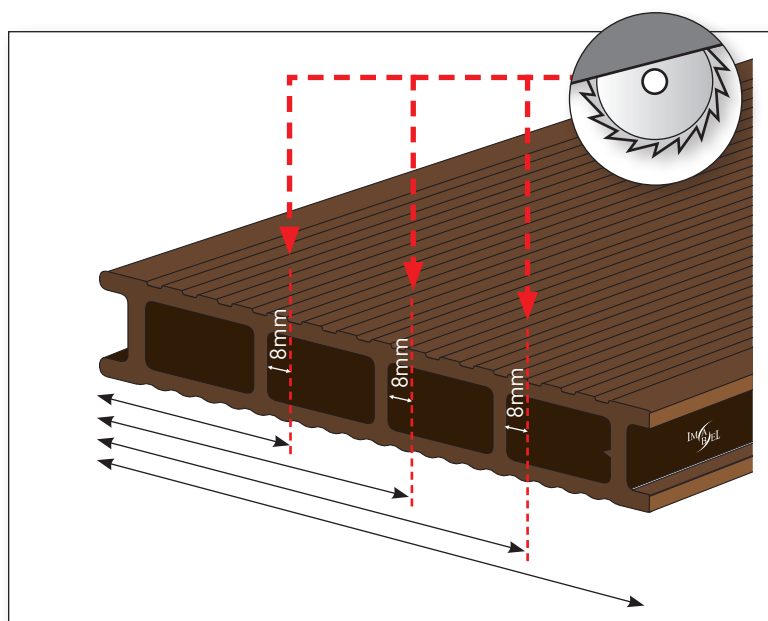

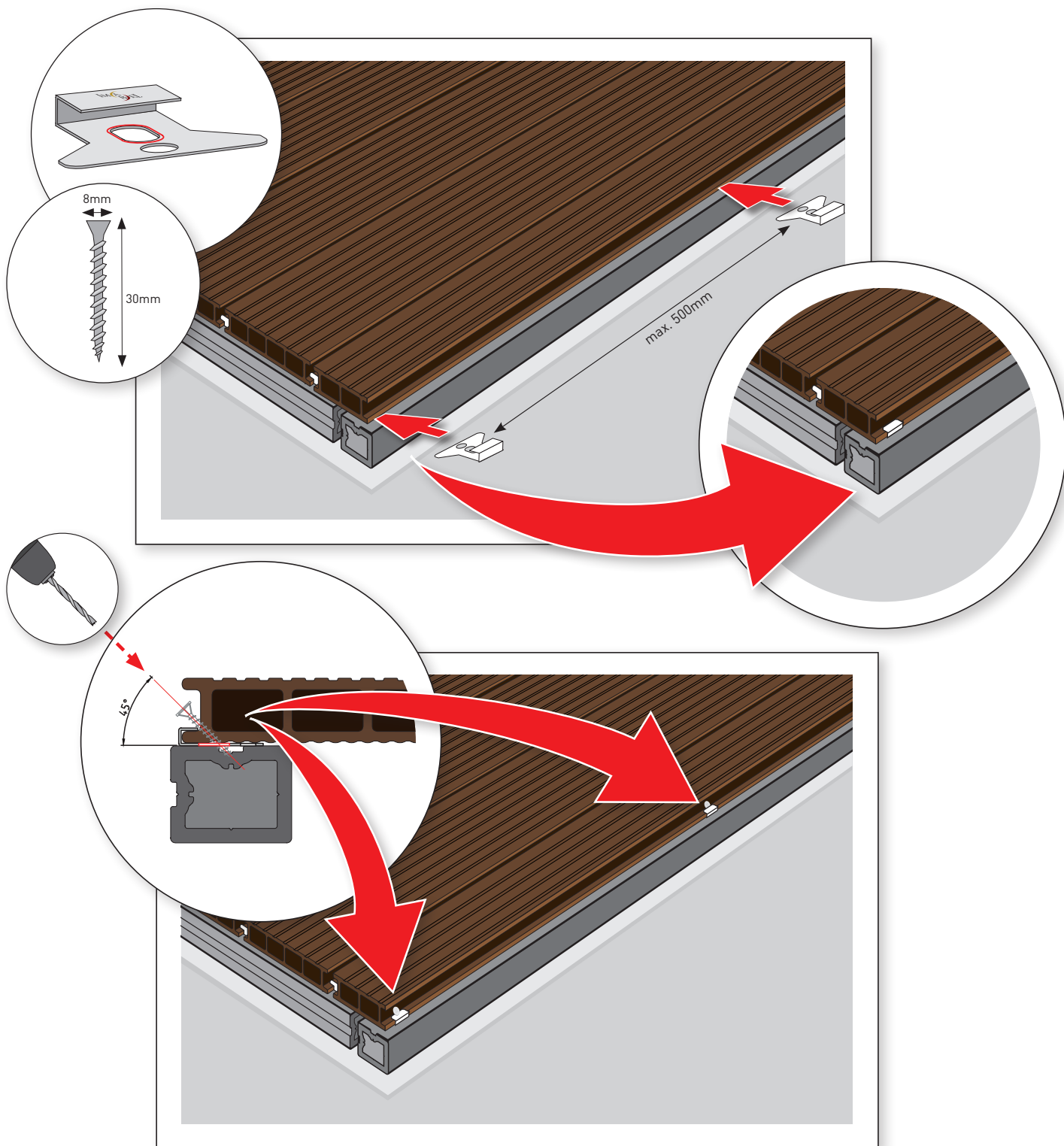

The last terrace board is secured in the side of the board. You must pre-drill the board.

Allow an **IMABEL** start- and end-clip for the end, to compensate for the difference in height caused by the **IMABEL** connecting clips.

As already stated in the general guidelines, you must allow for an initial expansion of at least 4 mm/m.

- Crosscut joints of two terrace boards must always be provided on the bearer. Allow for at least 10 mm of play. Add an extra piece of bearer at the joint so that 2 **IMABEL** connecting clips can be fitted. A connecting clip must never be fitted in the crosscut joint.

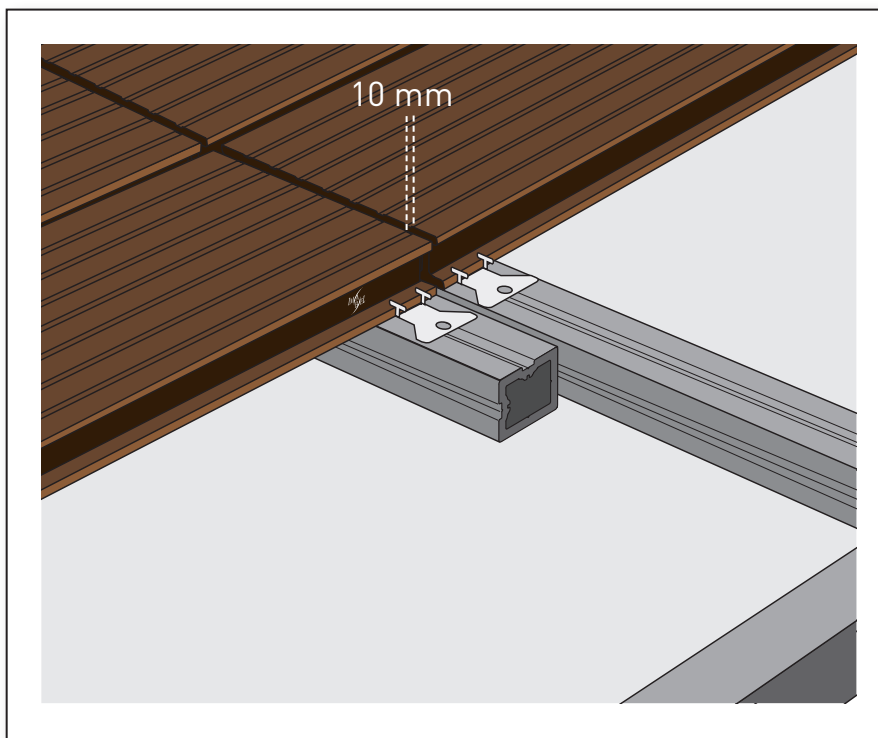

- A joint of at least 10 mm must also be provided between mitred terrace boards. The ends of both boards must be secured with an **IMABEL** connecting clip. Two bearers are required here.

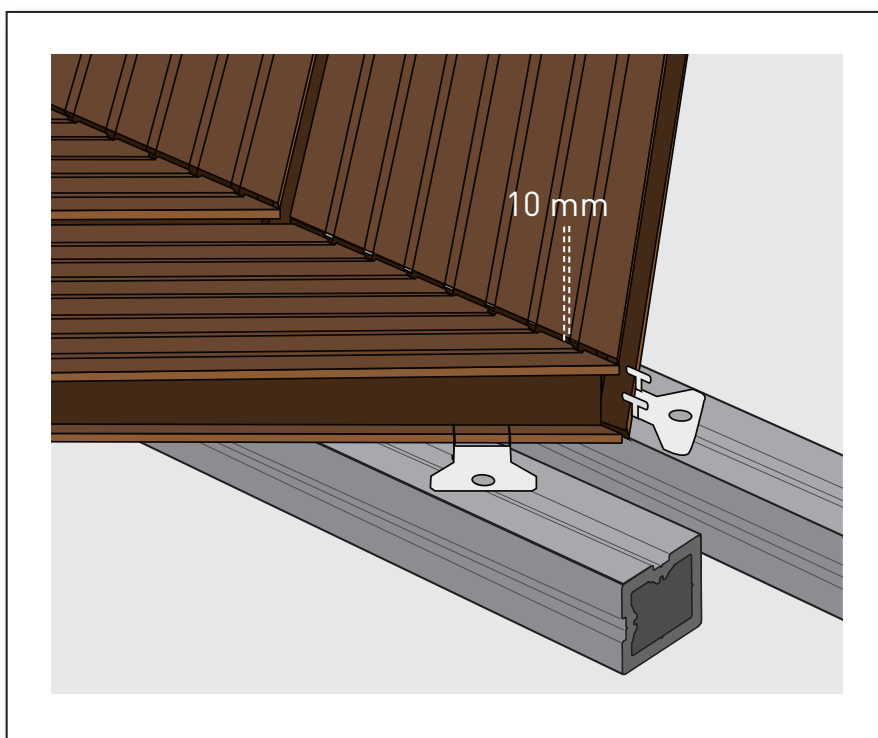

- If your terrace lies between two walls, you must allow a joint between the wall and the boards of at least 15 mm all round. You should also leave a joint of at least 15 mm between the wall and the underlying structure.

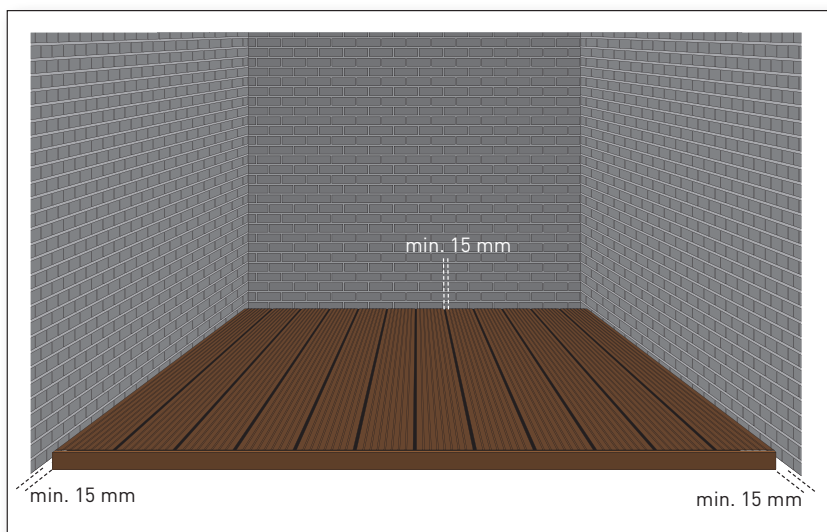

### Securing the skirting

- **IMABEL** skirting must be secured every 300 mm with 1 screw in the centre of the skirting. The first screw must be placed at a distance of at least 35 mm from the edge of the skirting. Use stainless steel screws 58 mm in length with diameter 4 and a countersunk head. Use a screwdriver with a depth limiter so that the screws cannot door- or come loose.

Respect a joint of at least 10 mm with crosscut joints between the terrace boards and the skirting.

Respect a joint of at least 5 mm when joining to the skirting along the length of the terrace boards.

Always provide continuous support behind the skirting.

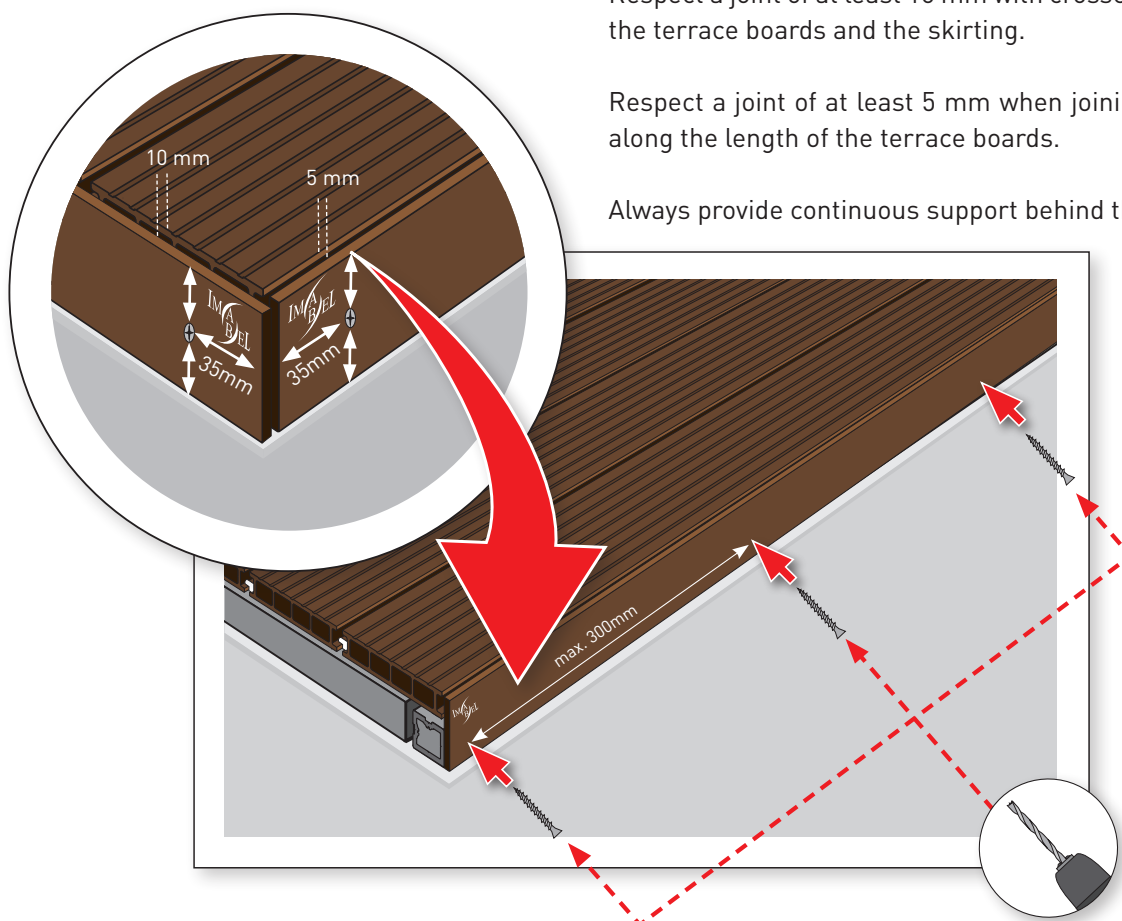

### Incorporating spotlights, drainpipes and the like

- Allow for at least 5 mm of play around the spotlight/drainpipe.  
Make sure that the free expansion of the boards is not restricted.  
Spotlights must not generate more than 60°C of heat.  
If necessary, fit an extra bearer below the spotlight.

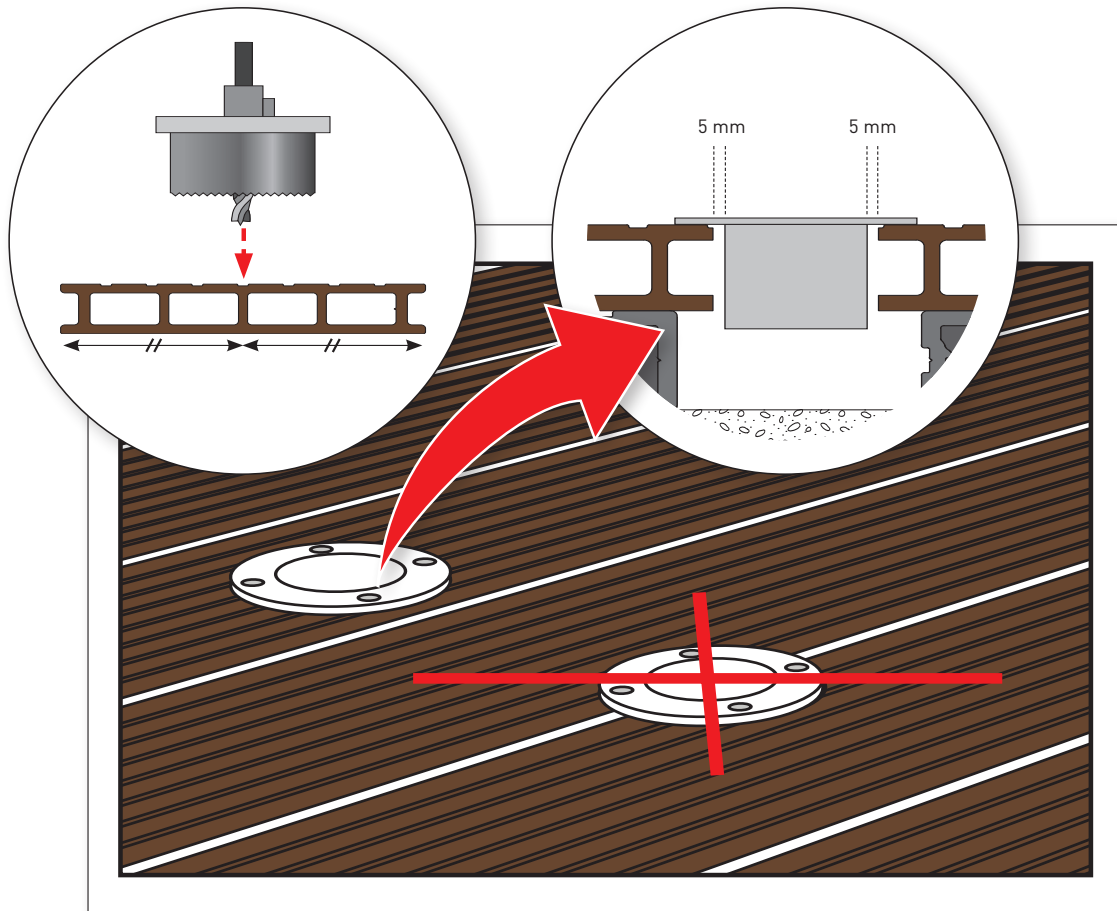

### Maintenance

- An **IMABEL** terrace is very easy to maintain.  
For normal maintenance you can use a high-pressure cleaner (maximum 80 bar). Respect a distance of at least 30 cm and always clean in the direction of the grooves. Avoid rotating movements.  
The use of a dirt-cutter is not recommended.

Grease and oil stains can be removed using a household degreaser.

Stubborn stains, burn marks, paint can be removed by gently sanding the surface with fine sandpaper, a steel brush or steel wool. Always sand in the direction of the grooves.



## Replacing damaged or broken terrace boards

- Saw the boards to be replaced into two pieces and remove them from the terrace. Position the new board and move it 10 mm in the direction of the desired position. Mark the position of the corners of the connecting clips. Remove the board and make a cut on the marks so that you can easily insert the board.

